

DESi

utopic^R

Wireless Motorized Cylinder
USER MANUAL



GENERAL INFORMATION and WARNINGS

- Before using your motorized cylinder, **Locking way (right or left handed door)** and **Number of turns** should be adjusted properly. Otherwise, the device will not work in the correct way and maybe broken.
- For emergency conditions, we recommend you to put the keys in an accessible place (like car, bag etc.)
- If there is any problem with the door or the locking mechanism, first of all, those problems have to be solved. The door's mechanical parts and locking mechanism have to work properly.
- If there is a problem with the device, first look to the troubleshooting part of this manual. If you cannot solve the problem, contact your dealer.
- All the system needs to be protected from water, direct sunlight and shocks.
- Auto-rotating parts of the device can cause injuries during installation. **BE CAREFUL!**
- If you are leaving your home for an extended period of time, first fully charge your motorized cylinder and take your mechanical key with you. If you would leave more than 2 months, after charging your motorized cylinder, either shift the motorized cylinder to childlock mode or leave your device as it is connected to charger. Otherwise, the batteries of your product would die due to deep discharge.

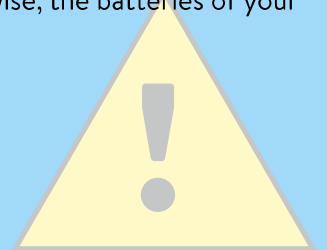

1. FEATURES OF THE DEVICE

Structure

ABS Plastic

Cylinder Length

(outside) 31 mm x 35 mm (inside)

Inside part can extensile up to 47 mm

(Different cylinder lengths are available)

Batteries and Battery Life

Your motorized cylinder is equipped with rechargeable Lithium Ion batteries.

According to DESi laboratory tests, with a usage of 10 operations per day on a 2 turns lock, battery life of motorized cylinder is as follows:

90* days (Either RF or BLE is active)

60* days (Both RF and BLE are active)

Communication Capability

Bluetooth Low Energy

ISM RF 434 Mhz

Control Options and Compatible Accessories

Wireless Fingerprint Readers

Wireless Keypad

Wireless Auto-Locking Module

Wireless Home Automation Interface

Remote Controllers

Remote Access Module

2. BOX CONTENT

(May vary according to model)

1x Wireless Motorized Cylinder (with keys)

1x Charging Cable (USB)

1x Installation screw and Hex key

3. PARTS OF DEVICE and INSTALLATION

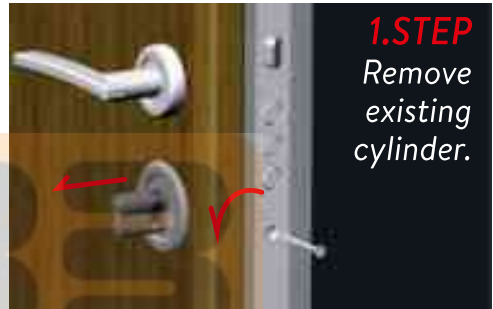
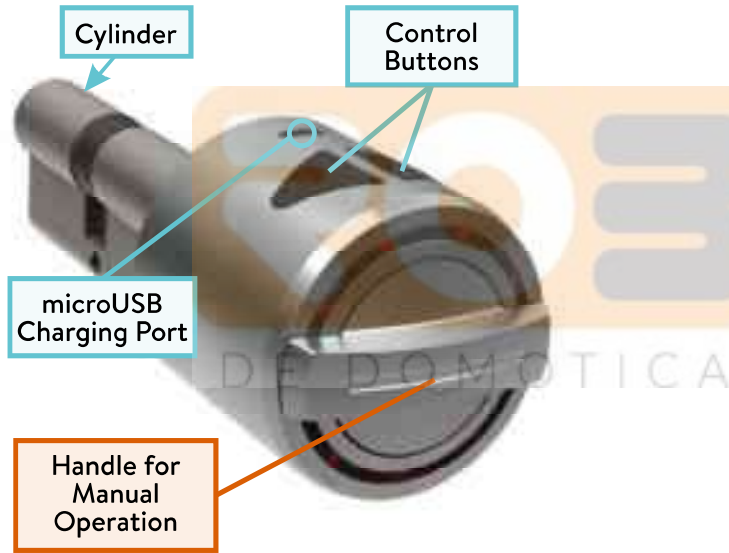

1. STEP
Remove existing cylinder.

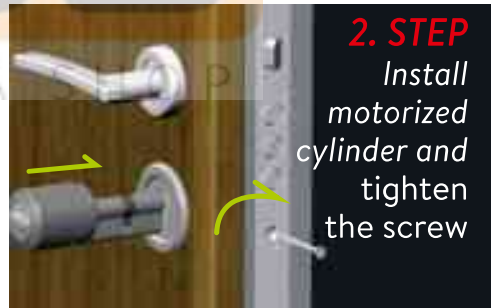

2. STEP
Install motorized cylinder and tighten the screw

In some security doors, even if you remove cylinder screw, you cannot remove cylinder due to cramped installation of cylinder defender. Follow the instructions below, for that kind of situations:

- Untighten the screws of the cylinder defender (don't remove the screws)
- Remove cylinder screw and take out the old cylinder.
- Disassemble the motorized knob from the cylinder.
- Install the cylinder part to the door and tighten the cylinder screw.
- Tighten the screws of the cylinder defender.
- Assemble the motorized knob with the cylinder.

DETACHING / ATTACHING MOTOR AND CYLINDER

Loosen the set screw with the hex key taken from the box. Pull the motor part out. To attach two parts, push the motor properly into cylinder and tighten the set screw.



Set Screw

4. MASTER CONTROLLER AND USER CONTROLLERS

The first controller enrolled to motorized cylinder is accepted as the master controller. The rest of the controllers will be user controllers. Both, master and user controllers can be used to lock/unlock the motorized cylinder but only the master controller can change settings of motorized cylinder.

MOBILE APPLICATION

In this section, you can find details about usage of Mobile Application

If you enroll your smart phone as first controller, it will be master controller of your motorized cylinder.

Before you use your motorized cylinder, you should adjust it properly according to the lock which motorized cylinder will work together. First, you should adjust “locking way” and then “number of rotation” (see page 10 and 11)

If you want to change the master controller of motorized cylinder, check “HOW TO RESET MOTORIZED CYLINDER” topic on the last page.

To use all available features of your device, we recommend you to use a smartphone as master controller.

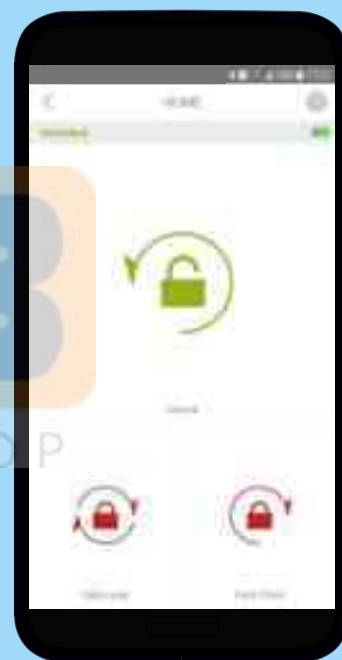

5.1. ENROLLING A MOBILE PHONE AS MASTER CONTROLLER

- Search “Desi Utopic” on stores. Download, install and run the application.
- Choose desired language and define a password.
- Press and hold two buttons on motorized cylinder until you hear long and short warning tones, then release buttons.
- On application screen, touch “+” in the top left corner to see the list of Utopic motorized cylinders around.
- Touch the UTOPIC line, enter a name for your device and touch the “green tick”. If a confirmation pop-up appears, confirm and device recognition process will start. If the matching is successful, you will hear 2 short tones from motorized cylinder and your mobile phone will be master controller of motorized cylinder.



NOTE: For Android phones, application will ask to reach location services. This is needed for using Bluetooth properly.

5.2. APPLICATION SETTINGS

If you touch the menu button in the top right corner when it is not connected to motorized cylinder, you will reach settings menu of application. Related menu items are as follows:

PASSWORD: You can disable, enable or change the password of application.

LANGUAGES: You can change language of the application.

APPLICATION SETTINGS: You can disable / enable auto-connection feature which connects to a known motorized cylinder around as soon as the application is launched.

APPLICATION INFO: You can see the version of installed application.

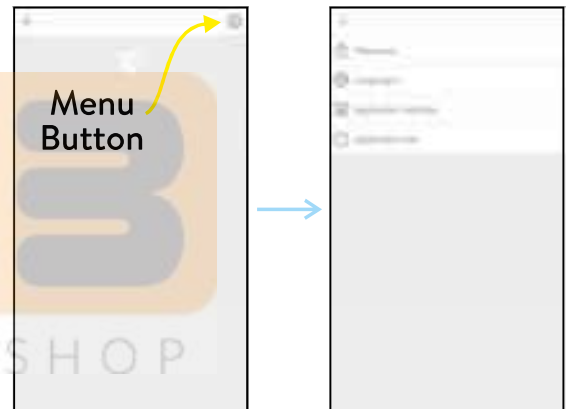

5.3. MOTORIZED CYLINDER SETTINGS / ADMINISTRATION MENU

If you touch the menu button in the top right corner when the application is connected to motorized cylinder as master controller, you will reach to settings menu of connected motorized cylinder. You can change settings of your motorized cylinder and perform administrative activities via this menu.

Before using your smart cylinder, “locking way” and “number of turns” settings must be adjusted properly. Otherwise, it will damage the device’s mechanical structure.

Related menu has 4 tabs: Device Info, Knob Settings, Users, Reports

5.3.1. DEVICE INFO TAB

In this tab, you can see following information:

- Device Name
- Device Type
- Device Firmware Version
- Battery Level
- Number of Enrolled Controllers
- Number of Operations (Locking or unlocking)

If you want to delete connected device from your mobile application, touch the “Delete Device” button in this menu.



5.3.2. KNOB SETTINGS TAB

In this tab, there are following menu items:

BUZZER OF KNOB: You can enable / disable activation sounds coming from motorized cylinder.

DELAYED LOCKING: Your motorized cylinder has a delayed locking feature which locks itself 5 second after you press the locking button on the motorized cylinder. If this feature is enabled, when you are going out, if you touch locking button on motorized cylinder and close the door in 5 seconds, it will lock the door automatically. In this menu item, you can enable / disable this feature.

AUTO LOCK: Your device has an automatic locking feature which locks itself 1 minute after it is unlocked. In this menu item, you can enable / disable this feature.

INVERT LOCKING WAY: You may need to change the direction of locking according to the door's way which you will use your motorized cylinder. You can invert locking way of device in this menu item.

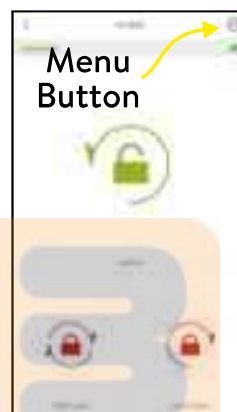

Knob Settings Tab

ADJUST NUMBER OF TURNS: Before using your motorized cylinder, you may need to adjust your motorized cylinder according to lock's number of rotation. For this purpose, close the door and then touch "Blue Rotating Arrow" button. Motorized cylinder will lock and then unlock the door and learn number of rotation.

AUTO DISCONNECTION TIME: You can adjust (with 5 sec. steps) the time period that application stays connected to motorized cylinder after it is connected.

LATCH RETRACTION PERIOD: According to type of your lock and its usage, you may need to adjust the time period which the motorized cylinder keeps latch of the lock inside when it unlocks the lock. You can use the slider to adjust latch retraction period in 4 different ways (from left to right): Short (around half second), 3 seconds, 6 second and 9 seconds.

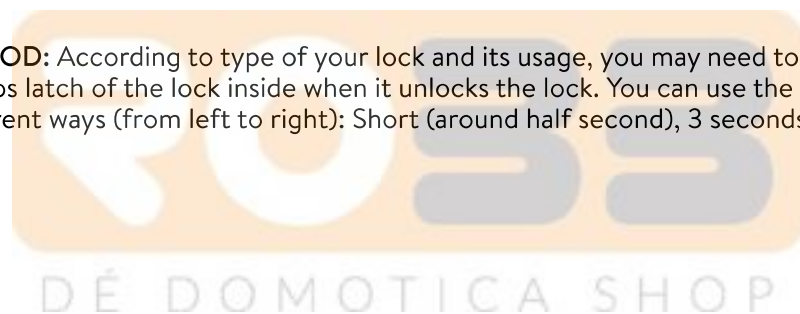

5.3.3. USERS TAB

In this tab, you can add, edit or delete (except master) controllers including accessories like auto-locking module, home automation interface, keypad etc.

EDIT / DELETE ENROLLED CONTROLLERS: If you touch the controllers title, you can see enrolled controllers of motorized cylinder. If you touch any users, you can reach dedicated page to edit name or delete the controller.

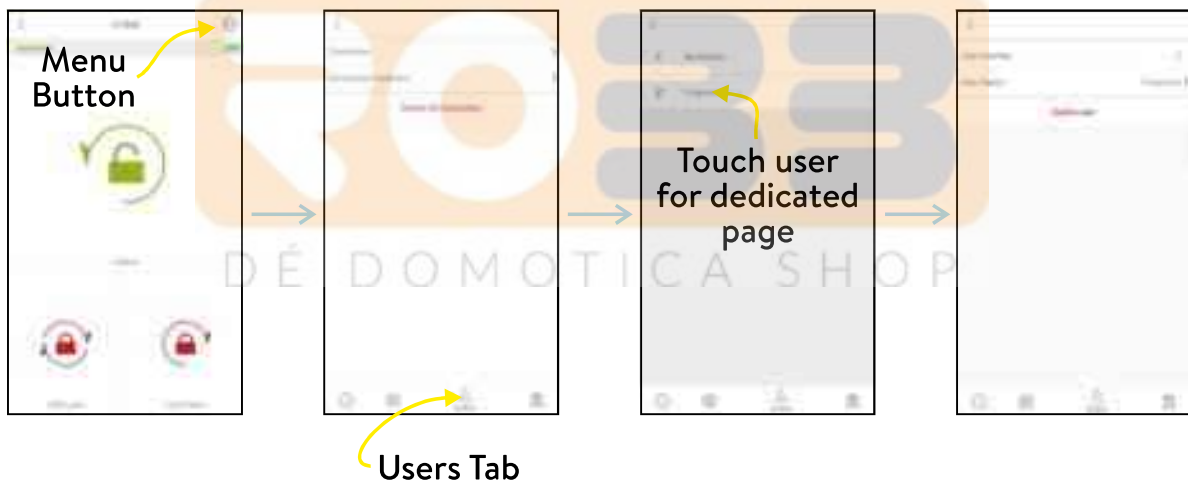

ENROLL NEW CONTROLLER:

Your motorized cylinder may learn up to 40 controllers. To shift your motorized cylinder to enrolling new controller mode, touch "Green Plus" button as shown. After touching button you will hear a long warning tone. After that tone, you need to send locking or unlocking signal via the new controller as explained below:

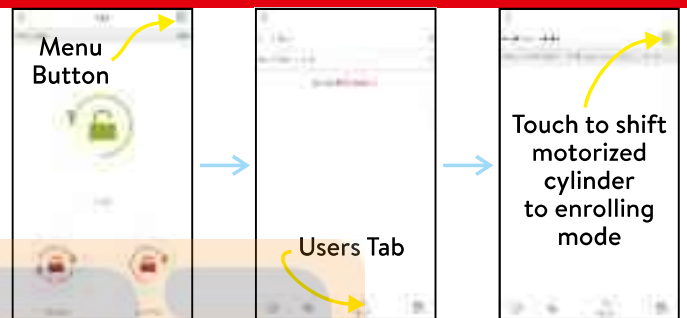

For fingerprint reader;

wake it up and touch the locking button.

For keypad;

wake it up and touch the locking button.

For remote controller;

press and hold any button.

For auto-locking module;

take the magnet closer to triangle sign and wait indicator is lit.

For home automation interface;

power up the device and short-circuit and then open-circuit yellow and black cables.

For **other controllers**, send locking or unlocking signal via related controller.

For enrolling a **new mobile phone**, please check next page.

ENROLLING A NEW (USER) MOBILE PHONE VIA MASTER MOBILE PHONE

- With **NEW MOBILE PHONE**, search “Desi Utopic” on stores. Download, install and run the application.
- Choose desired language and define a password.
- Touch “+” in the top left corner to see the list of Utopic motorized cylinders around.
- Touch the UTOPIC line and enter a name for your device and touch the “green tick”.
- A confirmation pop-up will appear. Before confirming, connect to motorized cylinder with **MASTER MOBILE PHONE** and touch menu button in the top right corner and go to Knob Settings Tab. Touch the “Green Plus” Button next to “ENROLL A NEW REMOTE CONTROLLER” line.
- Motorized cylinder will give a long (5 sec.) and then a short warning tones. After short warning tone, confirm the pop-up on **NEW MOBILE DEVICE**. Device recognition process will start. If the matching is successful, you will hear 2 short tones from motorized cylinder and your device will be one of user controller of motorized cylinder.

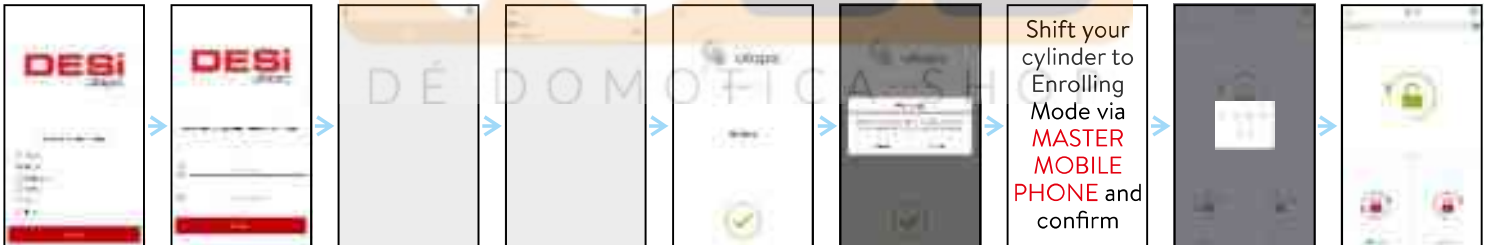

NOTE: For Android phones, application will ask to reach location services. This is needed for using Bluetooth properly.

DELETE ALL REMOTE CONTROLLERS

If you want to delete all the controllers of motorized cylinder, touch “Delete All Controllers”.
The master controller cannot be deleted by using this menu item.

5.3.4. REPORT TAB

In this tab, you can see which user unlocked or locked the device with time and date information.

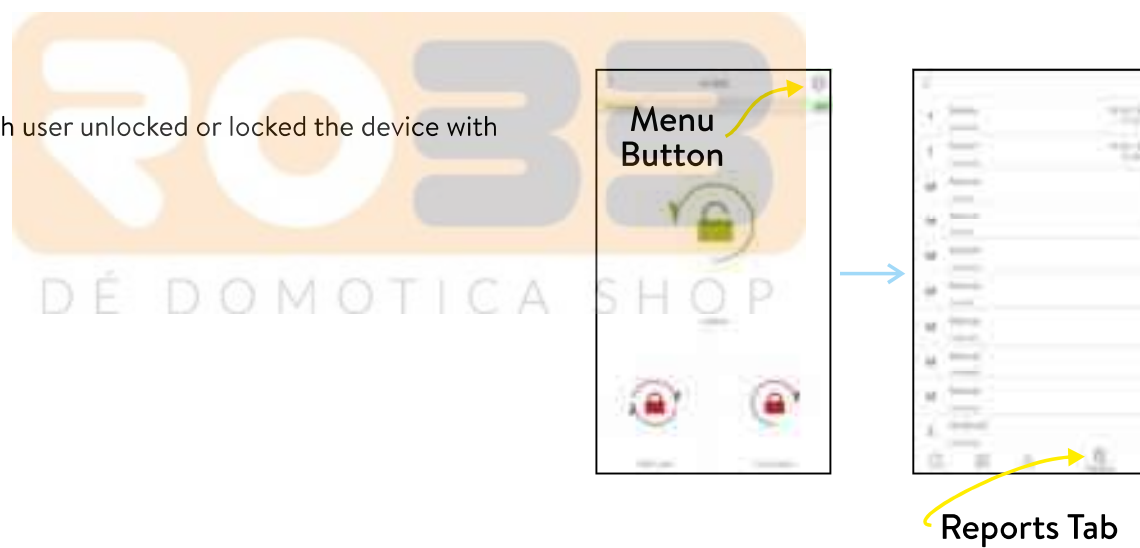

5.4. USAGE

Before you use your motorized cylinder, you should adjust it properly according to the lock which motorized cylinder will work together. First, you should adjust “direction of locking” and then “number of rotation” (see page 10 and 11)

5.4.1. UNLOCKING AND OPENING THE DOOR

Launch the app, connect to your motorized cylinder and touch UNLOCK button. Your motorized cylinder will unlock and open the door.

You can also unlock and open the door via button on motorized cylinder. For emergency conditions, the handle and key also can unlock and open the door.

5.4.2. LOCKING THE DOOR

Launch the app, connect to your motorized cylinder and touch either LOCK ONCE (to lock the door 1 turn) or FULLY LOCK (to lock all the turns) button. Your motorized cylinder will lock the door.

You can also lock the door via button on motorized cylinder. For emergency conditions, the handle and key also can lock the door.

5.4.3. CHILD LOCK

If you enable child lock feature, motorized cylinder will behave like a standard mechanical lock. You can use it either with a mechanical key or the handle only. **None of enrolled controllers (including master controller) will work** till child lock is disabled.

To enable child lock, press and hold two buttons on the motorized cylinder till you hear a long (3 sec.) warning tone. To disable child lock, press and hold two buttons on the motorized cylinder till you hear 3 short warning tones.

5.5. MAINTENANCE

You can clean external surfaces by soft, slightly damp cloth. Never use abrasive chemicals or water for this purpose. Don't try to disassemble your motorized cylinder.

5.5.1. CHARGING YOUR MOTORIZED CYLINDER

If you hear three short tones after operation of the motorized cylinder or if the rotation speed is too slow compared to normal working speed, you need to charge your motorized cylinder.

! ATTENTION !

- Charging period of your device is around 3 hours. We recommend you to charge it under supervision. We recommend to charge your device once in two months even if the batteries are not empty.
- With your own risk, you can use any 5 V DC microUSB chargers or a powerbank. Use high quality chargers, cables and powerbanks only.
- You may use your motorized cylinder as it is always connected to charger. The device will automatically adjust itself to work as always connected. (valid for firmware version 72 and higher.)
- If you are leaving your home for an extended period of time, first fully charge your motorized cylinder and take your mechanical key with you. If you would leave more than 2 months, after charging your motorized cylinder, either shift the motorized cylinder to child lock mode or leave your device as it is connected to charger. Otherwise, the batteries of your product will die due to deep discharge.

WIRELESS FINGERPRINT READER

In this section, you can find details about installation and usage of Wireless Fingerprint Reader.

Before using your motorized cylinder, first, you should adjust “**locking way**” and then “**number of rotation**” settings via master controller of your motorized cylinder. If master controller is fingerprint reader, please check page 25 and 26 for this purpose.

If you want to change the master controller of motorized cylinder, check “HOW TO RESET MOTORIZED CYLINDER” topic on the last page.

To use all available features of your device, we recommend you to use a smartphone as master controller.

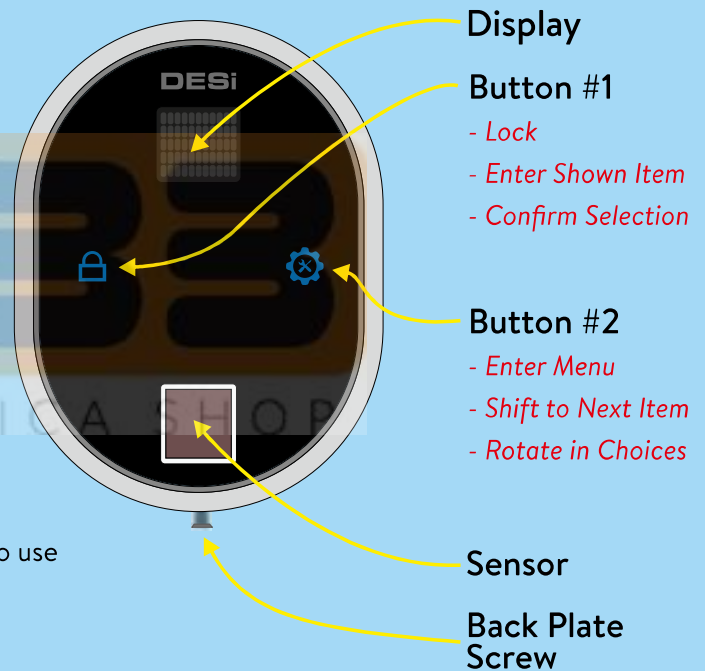

6.1. INSTALLATION OF WIRELESS FINGERPRINT READER

Unscrew back plate screw at the bottom of reader and separate pack plate from device. After that, follow the steps below:

1st Step



Place back plate to the desired location and fix it with 2 screws.

2nd Step

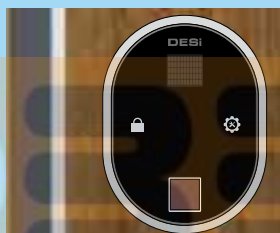

Place the device and tighten back plate screw.

6.2. ENROLLING FIRST (MASTER) FINGERPRINT

Fingerprint reader comes without any fingerprint in its memory. The first 3 fingerprints are accepted as master fingerprints and administrative activities like enrolling or deleting fingerprint can be done by master fingerprints only.

Master fingerprints need to be chosen carefully. Don't enroll a child's finger or any finger which is deformed (or can be deformed easily) as a master finger.

To enroll first fingerprint:

- Touch to device with your palm to wake it up. Touch "Button #2". First "OK" and then "LEARN" will be displayed.
- Touch "Button #1". "L3" will be displayed.
- Put the finger onto the reader till you see "OK" and remove. "L2" will be displayed.
- Put the same finger again till you see "OK" and remove. "L1" will be displayed.
- Put the same finger again till you see "OK".

After this step, your finger will be enrolled as first master. Schematic representation of operation is as follows:

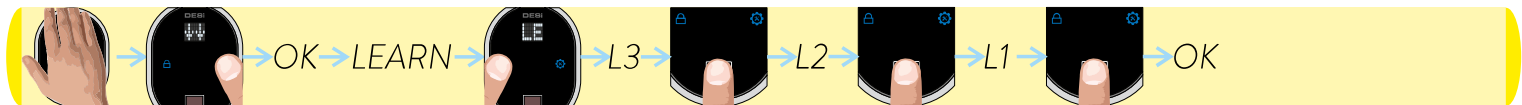

6.3. SETTINGS / ADMINISTRATION MENU

You can change settings of your motorized cylinder and perform administrative activities via this menu. Before using your smart cylinder, “number of turns” and “locking way” settings should be adjusted properly. Otherwise, it will damage the device’s mechanical structure or your lock.

The menu items and order is as follows:

Display	Function
② LEARN -①	Enrolling new fingerprints
② DELETE -①	Deleting enrolled fingerprints one by one
② RESET -①	Deleting all fingerprints (Resetting fingerprint reader)
② TURN -①	Adjusting motorized cylinder according to lock’s number of rotation to lock/unlock
② MOTOR -①	Adjusting direction of locking according to door’s opening way
② USER -①	Showing total number of enrolled fingerprints in the device’s memory
② SOUND -①	Enabling or disabling buzzer sound (Warning tones are always active)
② NIGHT -①	Enabling or disabling automatic locking mode which locks cylinder 1 minute after it is unlocked
② MANUAL -①	Enabling or disabling delayed locking which locks 5 s. after locking button on the cylinder is pressed.
② R.LEARN -①	Shifting the motorized cylinder to enrolling mode to learn new controllers
② R.DELETE -①	Deleting all controllers enrolled to cylinder except master controller.
② R.COUNT -①	Reporting number of controllers enrolled to motorized cylinder via buzzer sound
② HOLD.TM -①	Adjusting latch retraction period.

6.3.1. ENROLLING A NEW FINGERPRINT (LEARN)

If you want to enroll a new fingerprint to the reader, follow the steps below:

- Touch to device with your palm to wake it up. Two arrows will appear on display. Touch "Button #2". ADMIN will be shown.
- Put one of the master fingers onto the reader. First "OK" and then "LEARN" will be shown.
- Touch "Button #1" when "LEARN" is on display. "L3" will be shown.
- Put the finger to the reader till you see "OK" and remove. "L2" will be displayed.
- Put the same finger again till you see "OK" and remove. "L1" will be displayed.
- Put the same finger again till you see "OK".

In this way, the new fingerprint will be enrolled to the device. Schematic representation of operation is as follows:



NOTE 1: System assigns an id to fingers and this id is shown when finger is read.

NOTE 2: During enrollment, device reads the finger 3 times. If any of those reads doesn't match, "FALSE" code will be displayed and reader turns back to "L3" step. In this case, enrolling need to be repeated. Try to put your finger to the sensor in a similar way during all reads.

6.3.2. DELETING ENROLLED FINGERPRINTS ONE-BY-ONE (DELETE)

If you want to delete an enrolled fingerprint which you know the id number, follow the steps below:

- Touch to device with your palm to wake it up. Two arrows will appear on display. Touch "Button #2". ADMIN will be shown.
- Put one of the master fingers onto the reader. First "OK" and then "LEARN" will be shown.
- Touch "Button #2" till "DELETE" appears and touch "Button #1" when "DELETE" is on display. "02" will be shown.
- Touch "Button #2" till you see the fingerprint id you want to delete and touch "Button #1" when related id is on display.
- "OK" will be shown.

In this way, the related fingerprint will be deleted. Schematic representation of deleting a fingerprint (e.g. id is "07") is as follows:



DE DOMOTICA SHOP

NOTE 1: System assigns an id to fingers and this id is shown when finger is read. By mistake, if you pass the id of fingerprint you want to delete, wait a few seconds till display goes off and restart the procedure.

NOTE 2: First master fingerprint cannot be deleted in this way.

6.3.3. DELETING ALL FINGERPRINTS / RESET FINGERPRINT READER (RESET)

If you want to delete all enrolled fingerprint readers (including masters) , follow the steps below:

- Touch to device with your palm to wake it up. Two arrows will appear on display. Touch "Button #2". ADMIN will be shown.
- Put one of the master fingers onto the reader. First "OK" and then "LEARN" will be shown.
- Touch "Button #2" till "RESET" appears and touch "Button #1" when "RESET" is on display. "00" will be shown.
- Touch "Button #2" till you see "17" and touch "Button #1".
- "OK" will be shown.

In this way, all the fingerprints (including masters) will be deleted. Schematic representation of operation is as follows:



DE DOMOTICA SHOP

NOTE: If you pass "17" by mistake, don't touch any button and wait a few seconds till display goes off. After that restart the procedure.

6.3.4. ADJUSTING MOTORIZED CYLINDER ACCORDING TO LOCK'S NUMBER OF ROTATION TO LOCK/UNLOCK

To adjust your motorized cylinder according to lock's number of rotation, follows the steps below:

- First of all, close the door.
- Touch to device with your palm to wake it up. Two arrows will appear on display. Touch "Button #2". ADMIN will be shown.
- Put one of the master fingers onto the reader. First "OK" and then "LEARN" will be shown.
- Touch "Button #2" till "TURN" appears and touch "Button #1" when "TURN" is on display. "OK" will be shown and cylinder will automatically lock and unlock the door.

In this way, motorized cylinder will learn how many rotations is needed to lock / unlock the door. Schematic representation of operation is as follows:



DE DOMOTICA SHOP

6.3.5. ADJUSTING DIRECTION OF LOCKING ACCORDING TO DOOR'S OPENING WAY (MOTOR)

To adjust your motorized cylinder's locking way according to the door, follows the steps below:

- Touch to device with your palm to wake it up. Two arrows will appear on display. Touch "Button #2". ADMIN will be shown.
- Put one of the master fingers onto the reader. First "OK" and then "LEARN" will be shown.
- Touch "Button #2" till "MOTOR" appears and touch "Button #1" when "MOTOR" is on display. "RIGHT" or "LEFT" will be shown.
- Touch "Button #2" to toggle between;
 - "RIGHT" - right door,
 - "LEFT" - left door.
- When desired way is displayed, touch "Button #1". "OK" will be displayed.

In this way, motorized cylinder's direction of locking will be set. Schematic representation of changing direction of locking from right to left is as follows:

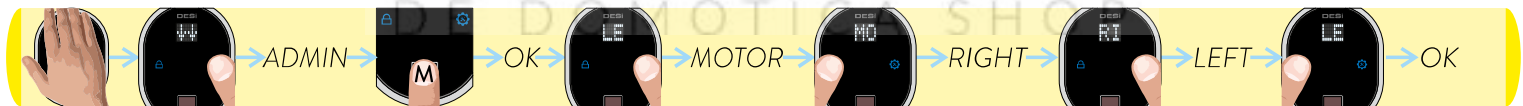

NOTE: To transfer settings to motorized cylinder, you need to lock or unlock motorized cylinder via master controller.

6.3.6. REPORTING TOTAL NUMBER OF ENROLLED FINGERS

To learn total number of fingerprints enrolled to the reader, follows the steps below:

- Touch to device with your palm to wake it up. Two arrows will appear on display. Touch "Button #2". ADMIN will be shown.
- Put one of the master fingers onto the reader. First "OK" and then "LEARN" will be shown.
- Touch "Button #2" till "USER" appears and touch "Button #1" when "USER" is on display.

In this way, number of enrolled fingerprints will be displayed. Schematic representation of this operation (which shows 8 fingerprints enrolled to reader) is as follows:



DÉ DOMOTICA SHOP

6.3.7. ENABLING OR DISABLING BUZZER SOUND

You can disable (or enable) activation sound of motorized cylinder by following steps below:

- Touch to device with your palm to wake it up. Two arrows will appear on display. Touch "Button #2". ADMIN will be shown.
- Put one of the master fingers onto the reader. First "OK" and then "LEARN" will be shown.
- Touch "Button #2" till "SOUND" appears and touch "Button #1" when "SOUND" is displayed. First "OK" then "ON" or "OFF" will be shown.
- Touch "Button #2" to toggle between;
 - "OFF" - buzzer is disabled
 - "ON" - buzzer is enabled.
- When desired choice is displayed, touch "Button #1". "OK" will be displayed.

In this way, desired buzzer choice will be set. Schematic representation of disabling buzzer sound is as follows:



NOTE: To transfer settings to motorized cylinder, you need to lock or unlock motorized cylinder via master controller.

6.3.8. AUTO-LOCKING FEATURE

Your device has an automatic locking feature which locks itself 1 minute after it is unlocked. If you enable this feature, you will be sure that your door is always locked.

You can enable or disable this feature by following steps below:

- Touch to device with your palm to wake it up. Two arrows will appear on display. Touch "Button #2". ADMIN will be shown.
- Put one of the master fingers onto the reader. First "OK" and then "LEARN" will be shown.
- Touch "Button #2" till "NIGHT" appears and touch "Button #1" when "NIGHT" is displayed. First "OK" then "ON" or "OFF" will be shown.
- Touch "Button #2" to toggle between;
 - "OFF" - auto-locking is disabled
 - "ON" - auto-locking is enabled.
- When desired choice is displayed, touch "Button #1". "OK" will be displayed.

In this way, desired auto-locking choice will be set. Schematic representation of enabling auto-locking is as follows:



NOTE: To transfer settings to motorized cylinder, you need to lock or unlock motorized cylinder via master controller.

6.3.9. DELAYED LOCKING FEATURE

Your motorized cylinder has a delayed locking feature which locks itself 5 second after you press the locking button on the motorized cylinder. If this feature is enabled, when you are going out, if you touch locking button on motorized cylinder and close the door in 5 seconds, it will lock the door automatically. You can enable or disable this feature by following steps below:

- Touch to device with your palm to wake it up. Two arrows will appear on display. Touch "Button #2". ADMIN will be shown.
- Put one of the master fingers onto the reader. First "OK" and then "LEARN" will be shown.
- Touch "Button #2" till "MANUAL" appears and touch "Button #1" when "MANUAL" is displayed. First "OK" then "ON or "OFF" will be shown.
- Touch "Button #2" to toggle between;
 - "OFF" - delayed locking is disabled,
 - "ON" - delayed locking is enabled.
- When desired choice is displayed, touch "Button #1". "OK" will be displayed.

In this way, desired delayed locking choice will be set. Schematic representation of enabling delayed locking is as follows:

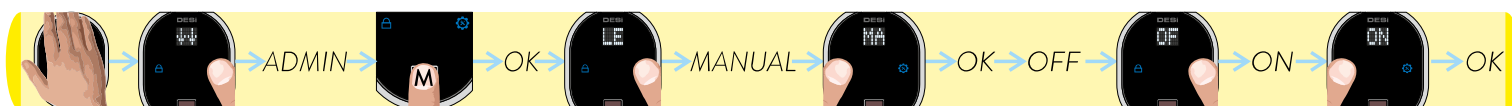

NOTE: To transfer settings to motorized cylinder, you need to lock or unlock motorized cylinder via master controller.

6.3.10. SHIFTING MOTORIZED CYLINDER TO ENROLLING NEW CONTROLLER MODE

- Touch to device with your palm to wake it up. Two arrows will appear on display. Touch "Button #2". ADMIN will be shown.
- Put one of the master fingers onto the reader. First "OK" and then "LEARN" will be shown.
- Touch the "Button #2" till "R.LEARN" appears and touch "Button #1" when "R.LEARN" is on display.
- "OK" will be displayed. The motorized cylinder will shift to enrolling new controller mode with a long and a short warning tone. Schematic representation of operation is as follows:

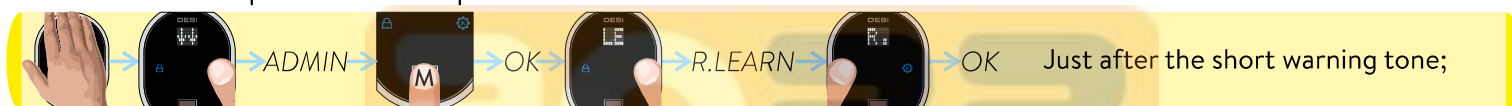

For keypad;



wake it up and touch the locking button.

For remote controller;



press and hold any button.

For enrolling a **new mobile phone**, please check next page.

For auto-locking module;

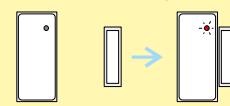

take the magnet closer to triangle sign and wait indicator is lit.

For home automation interface;



power up the device and short-circuit and then open-circuit yellow and black cables.

For **other controllers**, send locking or unlocking signal via related controller.

ENROLLING A NEW (USER) MOBILE PHONE

- With the phone that you want to enroll to your motorized cylinder, search “Desi Utopic” on stores. Download, install and run the application.
- Choose desired language and define a password.
- Shift the motorized cylinder to enrolling mode as explained previous page and touch “+” in the top left corner to see the list of Utopic motorized cylinders around.
- Touch the UTOPIC line and enter a name for your device and touch the “green tick”. Confirm the pop-up window. Device recognition process will start. If the matching is successful, you will hear 2 short tones from motorized cylinder and your device will be enrolled to the motorized cylinder as a user controller.



NOTE: For Android phones, application will ask to reach location services. This is needed for using Bluetooth properly.

6.3.11. DELETING ALL ENROLLED CONTROLLERS OF MOTORIZED CYLINDER EXCEPT MASTER CONTROLLER

To delete all enrolled controllers of your motorized cylinder, follows the steps below:

- Touch to device with your palm to wake it up. Two arrows will appear on display. Touch “Button #2”. ADMIN will be shown.
- Put one of the master fingers onto the reader. First “OK” and then “LEARN” will be shown.
- Touch the “Button #2” till “R.DELETE” appears and touch “Button #1” when “R.DELETE” is on display. ”OK” will be shown.
- Touch “Button #1”.
- “OK” will be shown.

In this way, motorized cylinder will delete all enrolled controllers of motorized cylinder with a long warning tone.

Schematic representation of operation is as follows:



NOTE: This operation doesn't delete master controller from motorized cylinder's memory. If you want to delete master controller as well, please check “HOW TO RESET MOTORIZED CYLINDER” topic on the last page.

6.3.12. REPORTING NUMBER OF ENROLLED CONTROLLERS VIA BUZZER SOUND

Your motorized cylinder can report number of enrolled controllers via buzzer sound. To do this, follows the steps below:

- Touch to device with your palm to wake it up. Two arrows will appear on display. Touch "Button #2". ADMIN will be shown.
- Put one of the master fingers onto the reader. First "OK" and then "LEARN" will be shown.
- Touch "Button #2" till "R.COUNT" appears and touch "Button #1" when "R.COUNT" is on display.
- "OK" will be displayed.

In this way, motorized cylinder will start to report number of enrolled controllers via short warning tones.

Schematic representation of operation is as follows:



DÉ DOMOTICA SHOP

6.3.13. ADJUSTING LATCH RETRACTION PERIOD (FOR SOME MODELS ONLY)

According to type of your lock and usage, you would need to adjust the time period which the motorized cylinder will keep latch of the lock inside when it unlocks the lock. To adjust latch retraction period, follows the steps below:

- Touch to device with your palm to wake it up. Two arrows will appear on display. Touch “Button #2”. ADMIN will be shown.
- Put one of the master fingers onto the reader. First “OK” and then “LEARN” will be shown.
- Touch “Button #2” till “HOLD.TM” appears and touch “Button #1” when “HOLD.TM” is on display. ”OSN”, “3SN”, “6SN” or “9SN” will be shown.
- Touch “Button #2” to choose toggle between;
 - “OSN” - Short Period (latch will be kept inside the lock around 1 second and then released)
 - “3SN” - Middle Period (latch will be kept inside the lock around 3 second and then released)
 - “6SN” - Long Period (latch will be kept inside the lock around 6 second and then released)
 - “9SN” - Longest Period (latch will be kept inside the lock around 9 second and then released)
- When desired choice is displayed, touch “Button #1”. “OK” will be displayed.

In this way, latch retraction period of motorized cylinder will be adjusted. Schematic representation of adjusting latch retraction period to 3 seconds is as follows:

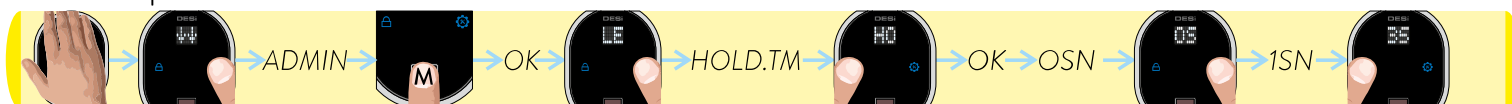

NOTE: To transfer settings to motorized cylinder, you need to lock or unlock motorized cylinder via master controller.

6.4. USAGE

Before using your motorized cylinder, you should adjust “locking way” and “number of rotation” according to lock which will be used with motorized cylinder.

6.4.1. UNLOCKING AND OPENING THE DOOR

Touch to device with your palm to wake it up and put an enrolled finger onto sensor. Fingerprint id will be displayed and motorized cylinder will unlock and open the door. If the finger is not known or recognized, “FALSE” will be displayed.

You can also unlock and open the door via button on motorized cylinder. For emergency conditions, the handle and key also can unlock and open the door.

6.4.2. LOCKING THE DOOR

Touch to device with your palm to wake it up and then touch locking button. System will lock the door.

You can also lock the door via button on motorized cylinder. For emergency conditions, the handle and key also can lock the door.

6.4.3. CHILD LOCK

If you enable child lock feature, motorized cylinder will behave like a standard mechanical lock. You can use it either with a mechanical key or the handle only. None of enrolled controllers (like fingerprint reader) will work till child lock is disabled. To enable child lock, press and hold two buttons on the motorized cylinder till you hear a long (3 sec.) warning tone. To disable child lock, press and hold two buttons on the motorized cylinder till you hear 3 short warning tones.

6.5. MAINTENANCE

You can clean external surfaces by soft, slightly damp cloth. Never use abrasive chemicals or water for this purpose. Don't try to disassemble your motorized cylinder.

6.5.1. CHARGING YOUR MOTORIZED CYLINDER

If you hear three short tones after operation of the motorized cylinder or if the rotation speed is too slow compared to normal working speed, you need to charge your motorized cylinders. For this purpose, we recommend to use provided charger and cable.

! ATTENTION !

- Charging period of your device is around 3 hours. We recommend you to charge it under supervision.
- With your own risk, you can use any 5 V DC microUSB chargers or a powerbank. Use high quality chargers, cables and powerbanks only.
- You may use your motorized cylinder as it is always connected to charger. The device will automatically adjust itself to work as always connected. (valid for firmware version 72 and higher.)
- If you are leaving your home for an extended period of time, first fully charge your motorized cylinder and take your mechanical key with you. If you would leave more than 2 months, after charging your motorized cylinder, either shift the motorized cylinder to childlock mode or leave your device as it is connected to charger. Otherwise, the batteries of your product would die due to deep discharge.

6.5.2. REPLACING FINGERPRINT READER'S BATTERY

If you start to see "BL" message on fingerprint reader's display, you need to replace the batteries. Get 2x AAA Alkaline (or 1,5V Lithium Batteries) and follow steps below:

- Unscrew back plate screw. Hold fingerprint reader from bottom part, pull and lift up to detach it from back plate.
- Replace the battery with new one. Watch the polarities!
- Attach fingerprint reader to back plate and tighten the screw.

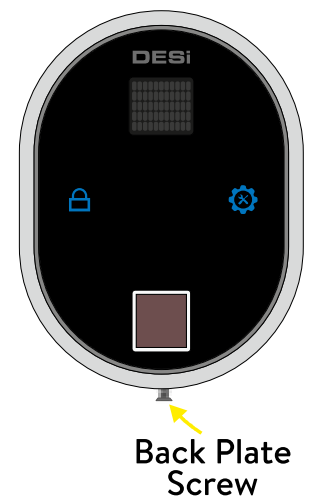



WIRELESS KEYPAD

In this section, you can find details about usage of Wireless Keypad

Before using your motorized cylinder, first, you should adjust “**locking way**” and then “**number of rotation**” settings via master controller of your motorized cylinder. If master controller is keypad, please check page 47 and 48 for this purpose.

If you want to change the master controller of motorized cylinder, check “HOW TO RESET MOTORIZED CYLINDER” topic on the last page.

To use all available features of your device, we recommend you to use a smartphone as master controller.

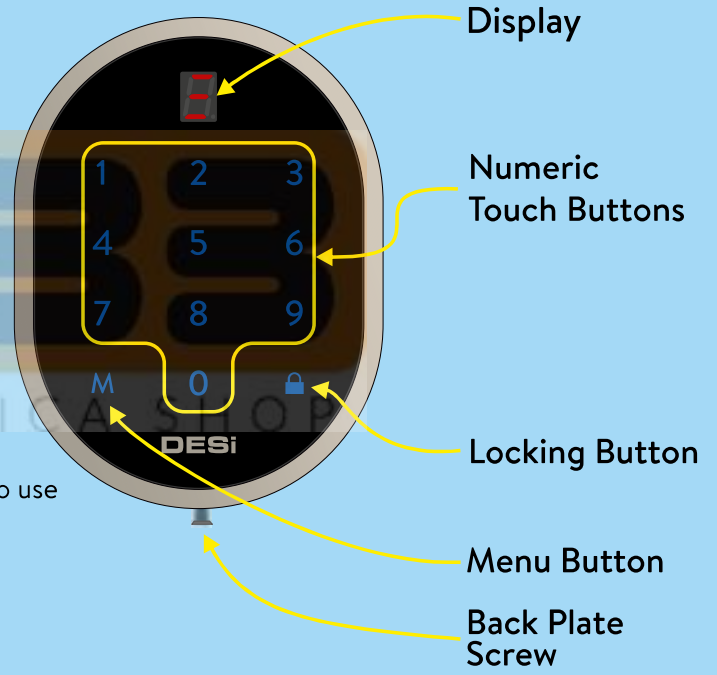

7.1. INSTALLATION OF WIRELESS KEYPAD

Unscrew back plate screw at the bottom of keypad and separate pack plate from device. After that, follow the steps below:

1st Step



Place back plate to the desired location and fix it with 2 screws.

2nd Step

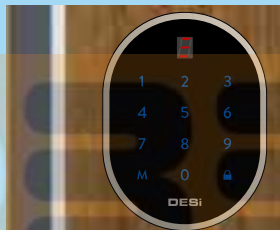

Place the device and tighten back plate screw.

7.2. CHANGING DEFAULT MASTER PASSWORD

Default master password of keypad is "12345". The first thing you need to do is changing default password as follows:

- Wake the keypad up by putting your palm to the touch keys and then touch "M" button. "A" appears on the display.
- Enter "12345" as password. After display animation, touch "M" button again. "b" appears on the display.
- Touch "1" button and enter the new master password in 5 digit.
- After display animation, re-enter the new master password.

In this way, the master password will be changed. Schematic representation of this operation is as follows:

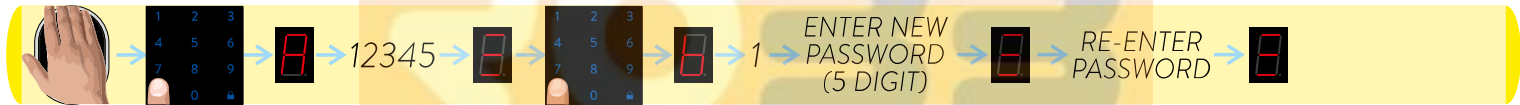

DÉ DOMOTICA SHOP

7.3. ADMINISTRATION ACTIONS / SETTINGS

Two different 5 digit passwords may be defined to the keypad; 1 master, 1 user. Both of the passwords can be use to unlock and open. For setting up device, the master password will be needed.

7.3.1. DEFINING / CHANGING USER PASSWORD

By default, there is no user password defined in your keypad.

- Wake the keypad up by putting your palm to the touch keys and then touch “M” button. “A” appears on the display.
- Enter 5 digit master password. After display animation, touch “M” button again. “b” appears on the display.
- Touch “2” button and enter the new user password in 5 digit. After display animation, re-enter the new user password.

In this way, the user password will be defined / changed. Schematic representation of this operation is as follows:

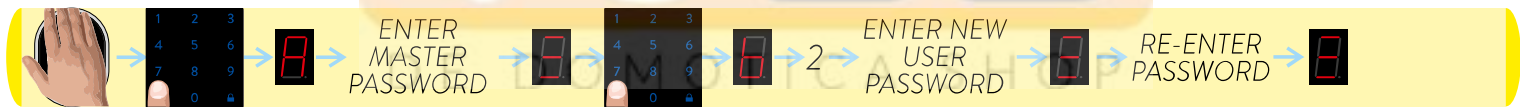

7.3.2. SHIFTING MOTORIZED CYLINDER TO ENROLLING NEW CONTROLLER MODE

- Wake the keypad up by putting your palm to the touch keys and then touch "M" button. "A" appears on the display.
- Enter 5 digit master password. After display animation, touch "6" button.
- The motorized cylinder will shift to enrolling new controller mode with a long and a short warning tone. Schematic representation of operation is as follows:

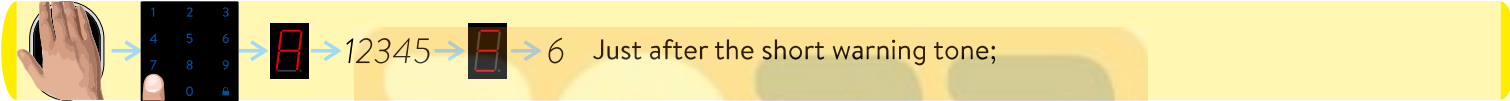

For fingerprint reader;

wake it up and touch the locking button.

For remote controller;

press and hold any button.

For enrolling a **new mobile phone**, please check next page.

For auto-locking module;

take the magnet closer to triangle sign and wait indicator is lit.

For home automation interface;

power up the device and short-circuit and then open-circuit yellow and black cables.

For **other controllers**, send locking or unlocking signal via related controller.

ENROLLING A NEW (USER) MOBILE PHONE

- With the phone that you want to enroll to your motorized cylinder, search “Desi Utopic” on stores. Download, install and run the application.
- Choose desired language and define a password.
- Shift the motorized cylinder to enrolling mode as explained previous page and touch “+” in the top left corner to see the list of Utopic motorized cylinders around.
- Touch the UTOPIC line and enter a name for your device and touch the “green tick”. Confirm the pop-up window. Device recognition process will start. If the matching is successful, you will hear 2 short tones from motorized cylinder and your device will be enrolled to the motorized cylinder as a user controller.

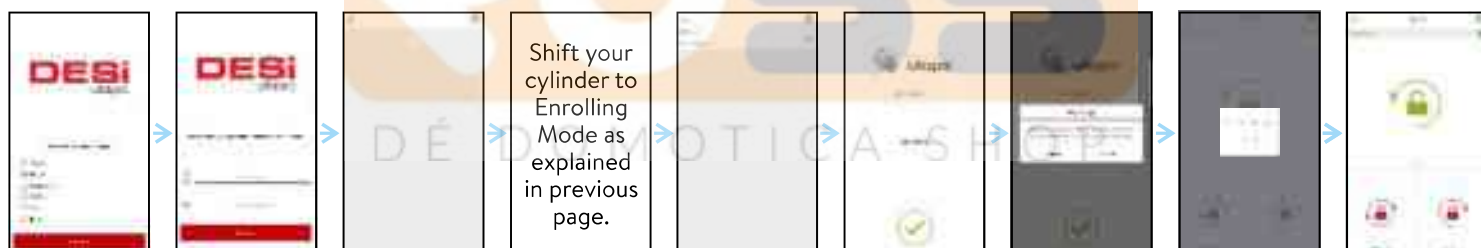

NOTE: For Android phones, application will ask to reach location services. This is needed for using Bluetooth properly.

7.3.3. DELETING ALL ENROLLED CONTROLLERS OF MOTORIZED CYLINDER EXCEPT MASTER CONTROLLER

- Wake the keypad up by putting your palm to the touch keys and then touch “M” button. “A” appears on the display.
- Enter 5 digit master password. After display animation, touch “7” button. “d” will be displayed.
- To confirm, touch lock button.

In this way, motorized cylinder will delete all enrolled controllers of motorized cylinder with a long warning tone. Schematic representation of operation is as follows:

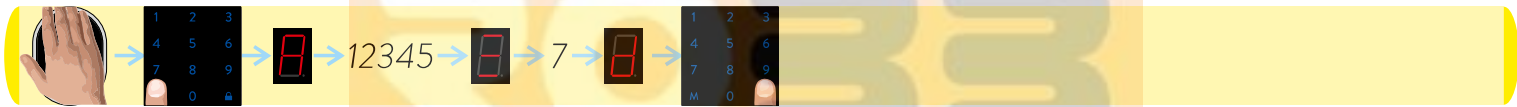

DÉ DOMOTICA SHOP

7.3.4. ADJUSTING DIRECTION OF LOCKING ACCORDING TO DOOR'S OPENING WAY

- Wake the keypad up by putting your palm to the touch keys and then touch "M" button. "A" appears on the display.
- Enter 5 digit master password. After display animation, touch "1" button. "r" or "L" will be displayed.
- Touch "LOCK" button to toggle between;
 - "r" - right door,
 - "L" - left door.
- When desired way is displayed, touch "M" button.

In this way, motorized cylinder's direction of locking will be set. Schematic representation of changing direction of locking from right to left is as follows:

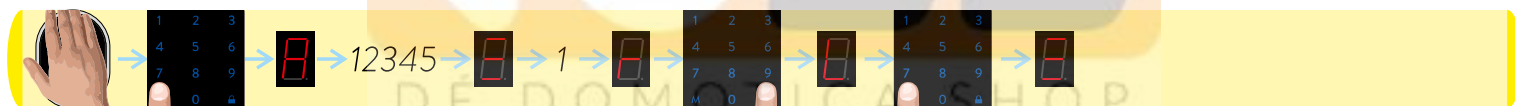

NOTE: To transfer settings to motorized cylinder, you need to lock or unlock motorized cylinder via master controller.

7.3.5. ADJUSTING MOTORIZED CYLINDER ACCORDING TO LOCK'S NUMBER OF ROTATION TO LOCK/UNLOCK

- First of all, close the door.
- Wake the keypad up by putting your palm to the touch keys and then touch "M" button. "A" appears on the display.
- Enter 5 digit master password. After display animation, touch "2" button.
- Motorized cylinder will automatically lock and unlock the door.

In this way, motorized cylinder will learn how many rotations is needed to lock / unlock the door. Schematic representation of operation is as follows:



DÉ DOMOTICA SHOP

7.3.6. REPORTING NUMBER OF ENROLLED CONTROLLERS VIA BUZZER SOUND

Your motorized cylinder can report number of enrolled controllers via buzzer sound. To do this, follows the steps below:

- Wake the keypad up by putting your palm to the touch keys and then touch “M” button. “A” appears on the display.
- Enter 5 digit master password. After display animation, touch “8” button.

In this way, motorized cylinder will start to report number of enrolled controllers via short warning tones.

Schematic representation of operation is as follows:



DÉ DOMOTICA SHOP

7.3.7. ENABLING OR DISABLING BUZZER SOUND

You can disabled (or enable) activation sounds by following steps below:

- Wake the keypad up by putting your palm to the touch keys and then touch "M" button. "A" appears on the display.
- Enter 5 digit master password. After display animation, touch "3" button. "O" or "c" will be displayed.
- Touch "LOCK" button to toggle between;
 - "O" - buzzer is enabled,
 - "C" - buzzer is disabled.
- When desired way is displayed, touch "M" button.

After first locking or unlocking operation done by keypad, selected settings will be applied to the system. Schematic representation of operation is as follows:

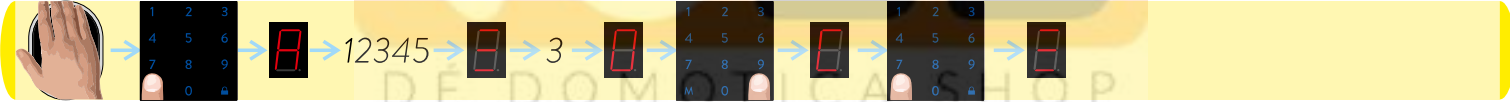

7.3.8. DELAYED LOCKING

Your motorized cylinder has a delayed locking feature which locks itself 5 second after you press the locking button on the motorized cylinder. If this feature is enabled, when you are going out, if you press locking button on motorized cylinder and close the door in 5 seconds, it will lock the door automatically. On this menu item, you can enable / disable this feature.

- Wake the keypad up by putting your palm to the touch keys and then touch "M" button. "A" appears on the display.
- Enter 5 digit master password. After display animation, touch "4" button. "o" or "C" will be displayed.
- Touch "LOCK" button to toggle between;
 - "O" - Delayed Locking is enabled,
 - "C" - Delayed Locking is disabled.
- When desired way is displayed, touch "M" button.

After first locking or unlocking operation done by keypad, selected settings will be applied to the system. Schematic representation of operation is as follows:

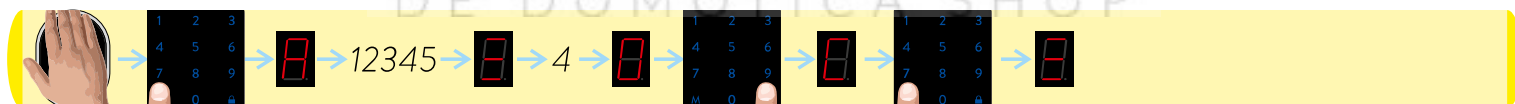

7.3.9. AUTOMATIC LOCKING

Your device has an automatic locking feature which locks itself 1 minute after it is unlocked. If you enable this feature, you will be sure that your door is always locked. You can enable or disable this feature by following steps below:

- Wake the keypad up by putting your palm to the touch keys and then touch "M" button. "A" appears on the display.
- Enter 5 digit master password. After display animation, touch "5" button. "o" or "C" will be displayed.
- Touch "LOCK" button to toggle between;
 - "O" - Automatic Locking is enabled,
 - "C" - Automatic Locking is disabled.
- When desired way is displayed, touch "M" button.

After first locking or unlocking operation done by keypad, selected settings will be applied to the system. Schematic representation of operation is as follows:



7.3.10. ADJUSTING LATCH RETRACTION PERIOD (FOR SOME MODELS ONLY)

According to type of your lock and usage, you would need to adjust the time period which the motorized cylinder will keep latch of the lock inside when it unlocks the lock. To adjust latch retraction period, follows the steps below:

- Wake the keypad up by putting your palm to the touch keys and then touch “M” button. “A” appears on the display.
- Enter 5 digit master password. After display animation, touch “9” button.
- Touch “LOCK” button to toggle between;
 - “0” - Short Period (latch will be kept inside the lock around 1 second and then released)
 - “1” - Middle Period (latch will be kept inside the lock around 3 second and then released)
 - “2” - Long Period (latch will be kept inside the lock around 6 second and then released)
 - “3” - Longest Period (latch will be kept inside the lock around 9 second and then released)
- When desired choice is displayed, touch “M” button.

After first locking or unlocking operation done by keypad, selected settings will be applied to the system. Schematic representation of adjusting latch retraction period to 3 seconds is as follows:

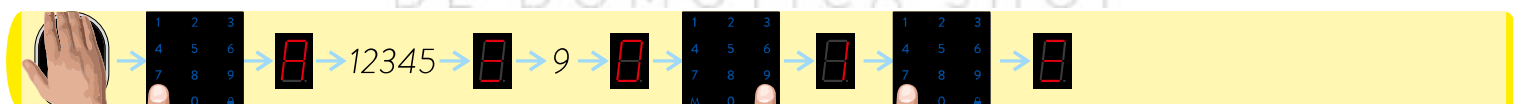

7.4. USAGE

Before using your motorized cylinder, you should adjust “locking way” and “number of rotation” according to lock which will be used with motorized cylinder.

7.4.1. UNLOCKING AND OPENING THE DOOR

Touch to device with your palm to wake it up and enter the password. Motorized cylinder will unlock and open the door. *You can also unlock and open the door via button on motorized cylinder. For emergency conditions, the handle and key also can unlock and open the door.*

7.4.2. LOCKING THE DOOR

Touch to device with your palm to wake it up and then touch locking button. Motorized cylinder will lock the door. *You can also lock the door via button on motorized cylinder. For emergency conditions, the handle and key also can lock the door.*

7.4.3. CHILD LOCK

If you enable child lock feature, motorized cylinder will behave like a standard mechanical lock. You can use it either with a mechanical key or the handle only. **None of enrolled controllers (including master controller) will work** till child lock is disabled.

To enable child lock, press and hold two buttons on the motorized cylinder till you hear a long (3 sec.) warning tone. To disable child lock, press and hold two buttons on the motorized cylinder till you hear 3 short warning tones.

7.5. MAINTENANCE

You can clean external surfaces by soft, slightly damp cloth. Never use abrasive chemicals or water for this purpose. Don't try to disassemble your motorized cylinder.

7.5.1. CHARGING YOUR MOTORIZED CYLINDER

If you hear three short tones after operation of the motorized cylinder or if the rotation speed is too slow compared to normal working speed, you need to charge your motorized cylinders. For this purpose, we recommend to use provided charger and cable.

! ATTENTION !

- Charging period of your device is around 3 hours. We recommend you to charge it under supervision.
- With your own risk, you can use any 5 V DC microUSB chargers or a powerbank. Use high quality chargers, cables and powerbanks only.
- You may use your motorized cylinder as it is always connected to charger. The device will automatically adjust itself to work as always connected. (valid for firmware version 72 and higher.)
- If you are leaving your home for an extended period of time, first fully charge your motorized cylinder and take your mechanical key with you. If you would leave more than 2 months, after charging your motorized cylinder, either shift the motorized cylinder to childlock mode or leave your device as it is connected to charger. Otherwise, the batteries of your product would die due to deep discharge.

7.5.2. REPLACING BATTERIES OF KEYPAD

If you start to see “b” message on keypad’s display or if you are getting problems to use keypad in a proper way (e.g. motorized cylinder doesn’t unlock the door even if you enter correct password) , you need to replace the batteries.

Get 2x AAA Alkaline (or 1,5V Lithium Batteries) and follow steps below:

- Unscrew back plate screw. Hold keypad from bottom part, pull and lift up to detach it from back plate.
- Replace the battery with new one. Watch the polarities!
- Attach keypad to back plate and tighten the screw.





REMOTE CONTROLLERS

In this section, you can find details about usage of Master and User Remote Controllers.

Before using your motorized cylinder, first, you should adjust “locking way” and then “number of rotation” settings via master controller of your motorized cylinder. If master controller is remote controller, please check page 62 and 63 for this purpose.

If you want to change the master controller of motorized cylinder, check “HOW TO RESET MOTORIZED CYLINDER” topic on the last page.

To use all available features of your device, we recommend you to use a smartphone as master controller.

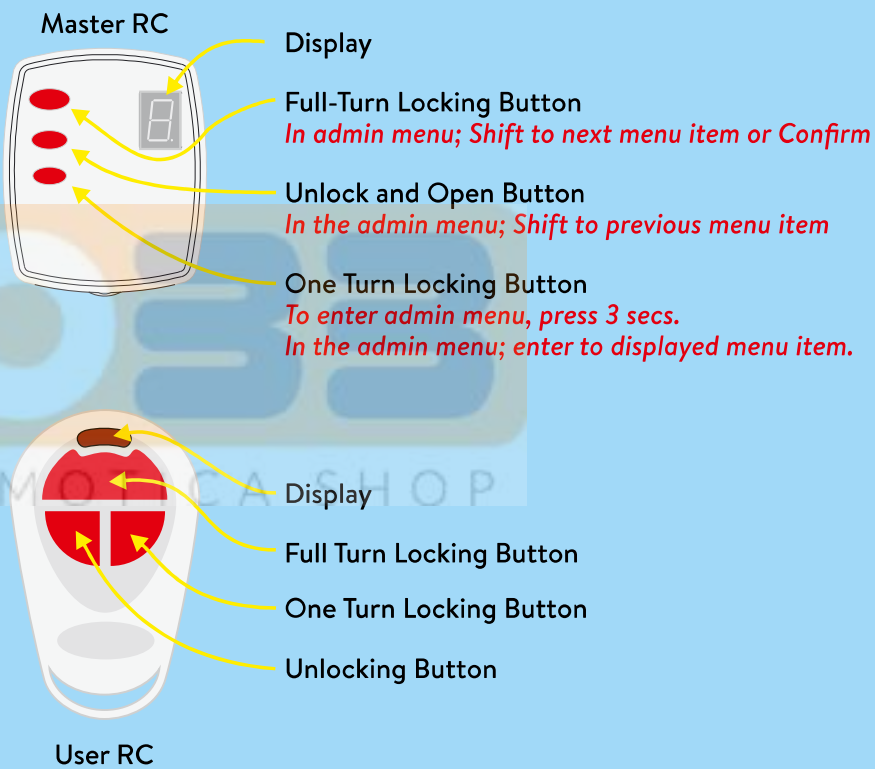

8.1. ADMINISTRATIVE ACTIONS / SETTINGS

8.1.1. ENROLLING NEW CONTROLLER

- Press and hold 3rd button till "0" flashes on the display.
- Press 2nd button four times. "6" will be flashing on the display.
- Press 3rd button. "L" will be appeared on the display and press 1st button.
- The cylinder will give a long and a short warning tone. Schematic representation of operation is as follows:

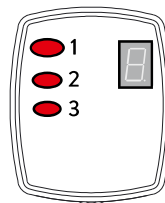

For fingerprint reader;

wake it up and touch the locking button.

For keypad;

wake it up and touch the locking button.

For remote controller;

press and hold any button.

For auto-locking module;

take the magnet closer to triangle sign and wait indicator is lit.

For home automation interface;

power up the device and short-circuit and then open-circuit yellow and black cables.

For **other controllers**, send locking or unlocking signal via related controller.

For enrolling a **new mobile phone**, please check next page.

ENROLLING A NEW (USER) MOBILE PHONE

- With the phone that you want to enroll to your motorized cylinder, search “Desi Utopic” on stores. Download, install and run the application.
- Choose desired language and define a password.
- Shift the motorized cylinder to enrolling mode as explained previous page and touch “+” in the top left corner to see the list of Utopic motorized cylinders around.
- Touch the UTOPIC line and enter a name for your device and touch the “green tick”. Confirm the pop-up window. Device recognition process will start. If the matching is successful, you will hear 2 short tones from motorized cylinder and your device will be enrolled to the motorized cylinder as a user controller.

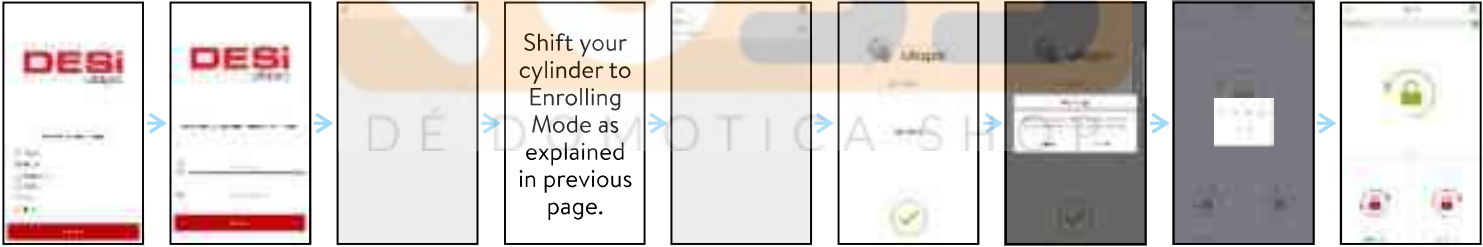

NOTE: For Android phones, application will ask to reach location services. This is needed for using Bluetooth properly.

8.1.2. DELETE ALL ENROLLED CONTROLLERS

- Press 3rd button till "0" flashes on the display.
- Press 2nd button three times. "7" will be flashing on the display. Press 3rd button. "d" will be shown.
- Press 1st button. The motorized cylinder will give a long (10 sec) and two short warning tone

In this way, all the controllers (**except the master rc**) will be deleted from the device.

Schematic representation of operation is as follows:

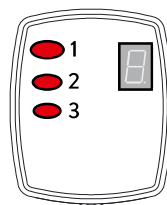

DÉ DOMOTICA SHOP

8.1.3. ADJUSTING DIRECTION OF LOCKING ACCORDING TO DOOR'S OPENING WAY

- Press 3rd button till "0" flashes on the display.
- Press 1st button one time. "1" will be flashing on the display.
- Press 3rd button. Either "r" or "L" will be shown on the display.
- For counter-clockwise locking, choose "L" by pressing 1st button, for clockwise locking, choose "r" by pressing 2nd button and then press 3rd button to confirm selection. Three lines will be shown on the display.

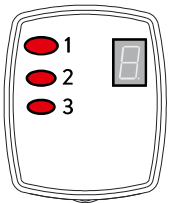

After first locking or unlocking operation done by master rc, selected settings will be applied to the system. Schematic representation of operation is as follows:



DÉ DOMOTICA SHOP

8.1.4. ADJUSTING MOTORIZED CYLINDER ACCORDING TO LOCK'S NUMBER OF ROTATION TO LOCK/UNLOCK

- Close the door and press 3rd button till "0" flashes on the display.
- Press 1st button two times. "2" will be flashing on the display.
- Press 3rd button. "o" will be shown on the display.
- Press 1st button. The motorized cylinder will give a long (3 sec) warning tone and it will lock and unlock the door.

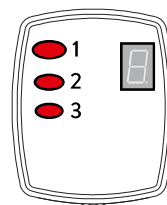

In this way, motorized cylinder learns the number of turns of the locking mechanism.

Schematic representation of operation is as follows:



DÉ DOMOTICA SHOP

8.1.5. REPORTING NUMBER OF CONTROLLERS IN THE MEMORY

- Press 3rd button till "0" flashes on the display.
- Press 2nd button two times. "8" will be flashing on the display.
- Press 3rd button. "C" will be shown on the display.
- Press 1st button.

The motorized cylinder reports number of remote controllers (and other wireless devices enrolled to the motorized cylinder) as warning signals. Schematic representation of operation is as follows:

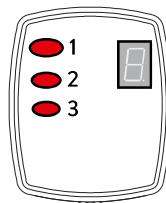

DÉ DOMOTICA SHOP

8.1.6. ADJUSTING BUZZER SOUND

- Press 3rd button till "0" flashes on the display.
- Press 1st button three times. "3" will be flashing on the display.
- Press 3rd button. Either "O" or "C" will be shown on the display.
- For disabling buzzer sound, choose "C" by pressing 1st button, for enabling buzzer sound, choose "O" by pressing 2nd button and then press 3rd button to confirm selection. Three lines will be shown on the display.

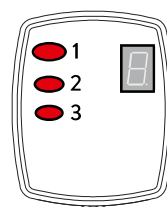

After first locking or unlocking operation done by master rc, selected settings will be applied to the system. Schematic representation of operation is as follows:



DÉ DOMOTICA SHOP

8.1.7. DELAYED LOCKING

Your motorized cylinder has a delayed locking feature which locks itself 5 second after you press the locking button on the motorized cylinder. If this feature is enabled, when you are going out, if you touch locking button on motorized cylinder and close the door in 5 seconds, it will lock the door automatically. On this menu item, you can enable / disable this feature.

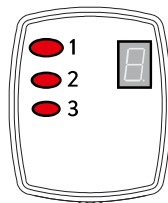

- Press 3rd button till "0" flashes on the display.
- Press 1st button four times. "4" will be flashing on the display.
- Press 3rd button. Either "O" or "C" will be shown on the display.
- For disabling delayed locking, choose "C" by pressing 1st button, for enabling it, choose "O" by pressing 2nd button and then press 3rd button to confirm selection. Three lines will be shown on the display.

After first locking or unlocking operation done by master rc, selected settings will be applied to the system. Schematic representation of operation is as follows:

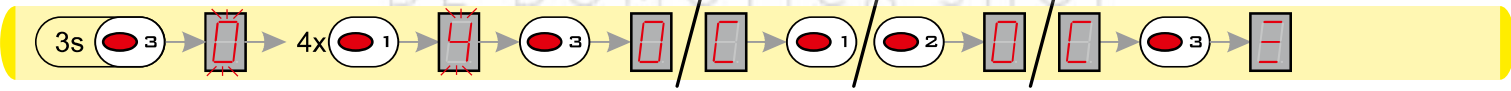

8.1.8. AUTOMATIC LOCKING

Your device has an automatic locking feature which locks itself 1 minute after it is unlocked. On this menu item, you can enable / disable this feature.

- Press 3rd button till "0" flashes on the display.
- Press 2nd button five times. "5" will be flashing on the display.
- Press 3rd button. Either "O" or "C" will be shown on the display.
- For disabling automatic locking, choose "C" by pressing 1st button, for enabling automatic locking, choose "O" by pressing 2nd button and then press 3rd button to confirm selection. Three lines will be shown on the display.

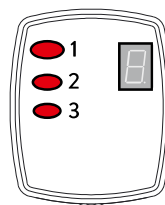

After first locking or unlocking operation done by master rc, selected settings will be applied to the system. Schematic representation of operation is as follows:



8.1.9. ADJUSTING LATCH RETRACTION PERIOD (FOR SOME MODELS ONLY)

According to type of your lock and usage, you would need to adjust the time period which the motorized cylinder will keep latch of the lock inside when it unlocks the lock. To adjust latch retraction period, follows the steps below:

- Press 3rd button till "0" flashes on the display.
- Press 2nd button one time. "9" will be flashing on the display.
- Press 3rd button. "0", "1", "2" or "3" will be shown on the display.
- Use 1st and 2nd buttons to choose one of following options;
 - "0" - Short Period (latch will be kept inside the lock around 1 second and then released)
 - "1" - Middle Period (latch will be kept inside the lock around 3 second and then released)
 - "2" - Long Period (latch will be kept inside the lock around 6 second and then released)
 - "3" - Longest Period (latch will be kept inside the lock around 9 second and then released)
- When desired choice is displayed, press to 3rd button.

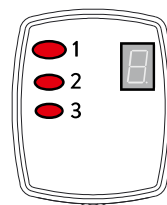

After first locking or unlocking operation done by master remote controller, selected settings will be applied to the system. Schematic representation of adjusting latch retraction period to 3 seconds is as follows:

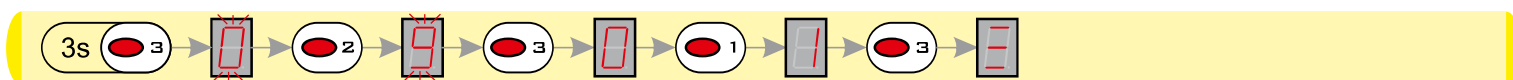

8.2. USAGE

Before using your motorized cylinder, you should adjust “locking way” and “number of rotation” according to lock which will be used with motorized cylinder.

8.2.1. UNLOCKING AND OPENING THE DOOR

Press 2nd button. Motorized cylinder will unlock and open the door.

You can also unlock and open the door via button on motorized cylinder.

For emergency conditions, the handle and key also can unlock and open the door.

8.2.2. LOCKING THE DOOR

Press either 3rd button (to lock the door 1 turn) or 1st button (to lock all the turns). Motorized cylinder will lock the door.

You can also lock the door via button on motorized cylinder. For emergency conditions, the handle and key also can lock the door.

8.2.3. CHILD LOCK

If you enable child lock feature, motorized cylinder will behave like a standard mechanical lock. You can use it either with a mechanical key or the handle only. **None of enrolled controllers (including master controller) will work** till child lock is disabled.

To enable child lock, press and hold two buttons on the motorized cylinder till you hear a long (3 sec.) warning tone. To disable child lock, press and hold two buttons on the motorized cylinder till you hear 3 short warning tones.

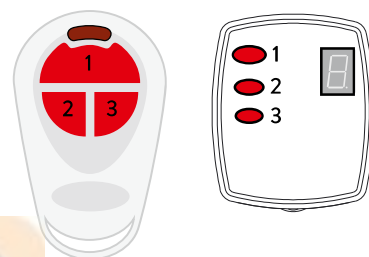

8.3. MAINTENANCE

You can clean external surfaces by soft, slightly damp cloth. Never use abrasive chemicals or water for this purpose. Don't try to disassemble your motorized cylinder.

8.3.1. CHARGING YOUR MOTORIZED CYLINDER

If you hear three short tones after operation of the motorized cylinder or if the rotation speed is too slow compared to normal working speed, you need to charge your motorized cylinders. For this purpose, we recommend to use provided charger and cable.

! ATTENTION !

- Charging period of your device is around 3 hours. We recommend you to charge it under supervision.
- With your own risk, you can use any 5 V DC microUSB chargers or a powerbank. Use high quality chargers, cables and powerbanks only.
- You may use your motorized cylinder as it is always connected to charger. The device will automatically adjust itself to work as always connected. (valid for firmware version 72 and higher.)
- If you are leaving your home for an extended period of time, first fully charge your motorized cylinder and take your mechanical key with you. If you would leave more than 2 months, after charging your motorized cylinder, either shift the motorized cylinder to childlock mode or leave your device as it is connected to charger. Otherwise, the batteries of your product would die due to deep discharge.

8.3.2. REPLACING REMOTE CONTROLLER'S BATTERY

If the controlling range of rc is getting shorter, battery of rc need to be changed. User and master rc are using 3V 2032 type lithium battery. To change the battery;

- Untighten screws and open the cover carefully.
- Change the battery by watching polarities.
- Close the cover and tighten the screws.

It is recommended to change the battery by a professional technician.

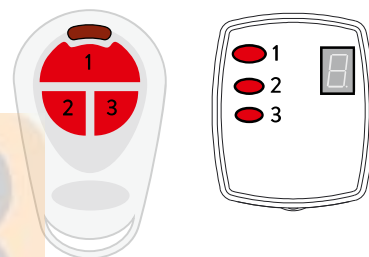

RO33
DÉ DOMOTICA SHOP

9. TROUBLESHOOTING

IF THE MOTORIZED CYLINDER CANNOT FULLY LOCK/UNLOCK THE DOOR

There can be high friction on the lock or latch bolt. It may be caused by sag of the door or unadjusted locking mechanism. Check if you can open the lock and latch with a key easily. If there is a problem on door or lock, that need to be fixed.

Batteries of motorized cylinder may be weak. Recharge the batteries.

IF DOOR IS NOT OPENED EVEN THE KNOB IS ROTATING

There is a problem related with connection between motor and cylinder. Call your dealer and ask for service.

IF CONTROLLERS ARE NOT OPERATING THE MOTORIZED CYLINDER

Child lock would be activated. To deactivate child lock, press two buttons on motorized cylinder and wait till you hear 3 short warning tones.

IF YOU CANNOT ADJUST THE SETTINGS OF MOTORIZED CYLINDER WITH THE CONTROLLER

The controller is not enrolled to the motorized cylinder as master controller. If you want to change the master controller of motorized cylinder, check "HOW TO RESET MOTORIZED CYLINDER" topic on the last page.

10. HOW TO RESET MOTORIZED CYLINDER

If you want to change master controller of your motorized cylinder or if you want to delete all controllers enrolled to the device, you can reset your motorized cylinder as follows:

- Press and hold 2 buttons on the motorized knob. A long warning tone will be heard. Continue to hold the buttons. After a while, second warning tone will start.
- During second warning tone, release the buttons and plug the provided charger into charging port of motorized cylinder as soon as possible. Charger should be plugged to electricity as well.
- After a while, double tone and then triple tone will be heard and all the controllers, including master controller, enrolled to the device will be deleted.

After resetting the motorized cylinder, please check if old master controller of motorized cylinder is deleted or not. If it is not deleted, repeat the procedure above.

If it is deleted, press and hold 2 buttons on the motorized cylinder till you hear a long warning tone. After that send a controlling signal via the desired master controller as follows:

- For mobile phone, please check page 7.
- For fingerprint reader, wake the fingerprint reader up and touch the locking button.
- For keypad, what the keypad up and touch the locking button.
- For master remote controller, press and hold button #2 till the motorized cylinder starts to operate.

DESi

www.desi.com.tr



copyright © DESi Alarm and Security Systems Inc.