

1. Install Home Assistant

Please install Home Assistant from the official link below:

<https://www.home-assistant.io/installation/>

2. Configure Home Assistant

Run your Home Assistant after successful installation. Open your browser and enter the following URL in the address bar: `http://ip-address:8123`, where ip-address is the IP address of the system where Home Assistant is installed. For example, if the IP address is 192.167.1.23, you need to enter <http://192.167.1.23:8123> in the address bar, then press Enter to access Home Assistant, as shown below:

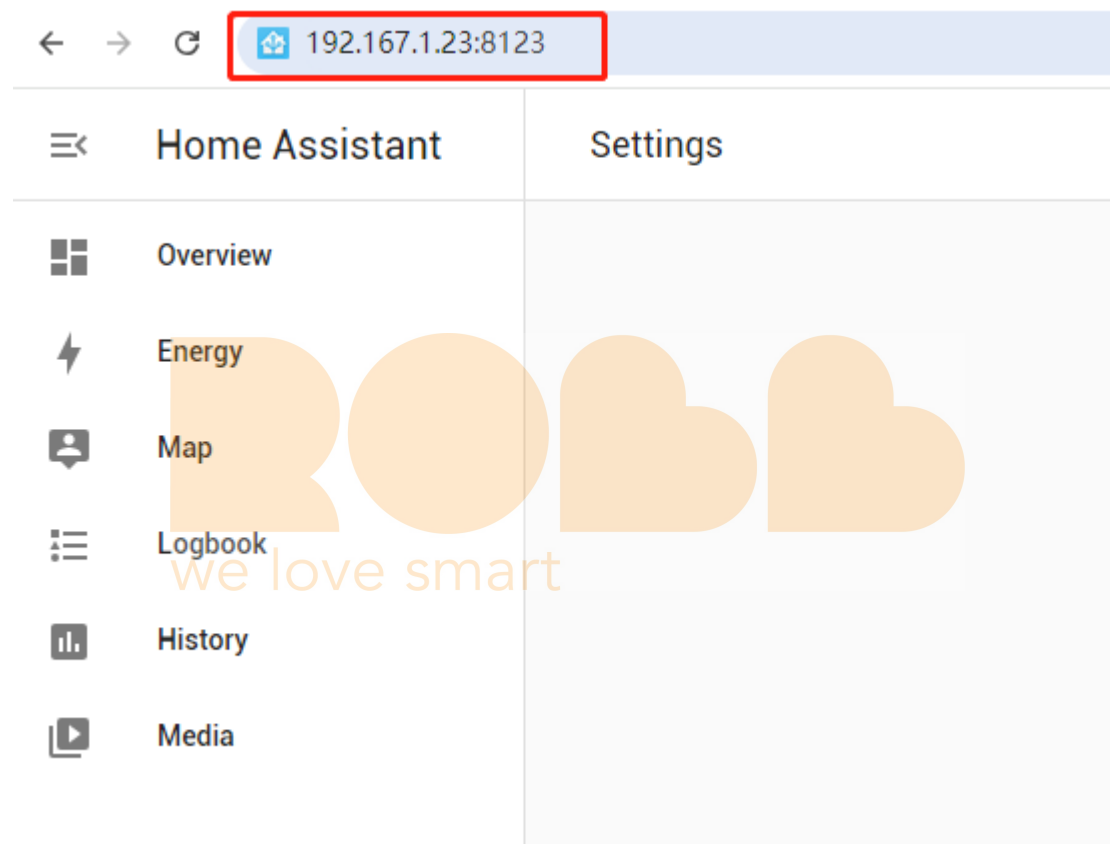

When opened for the first time, Home Assistant will prompt you to create a User, skip this step.

Step1: In Home Assistant, select Settings - Devices & Services, as shown below:

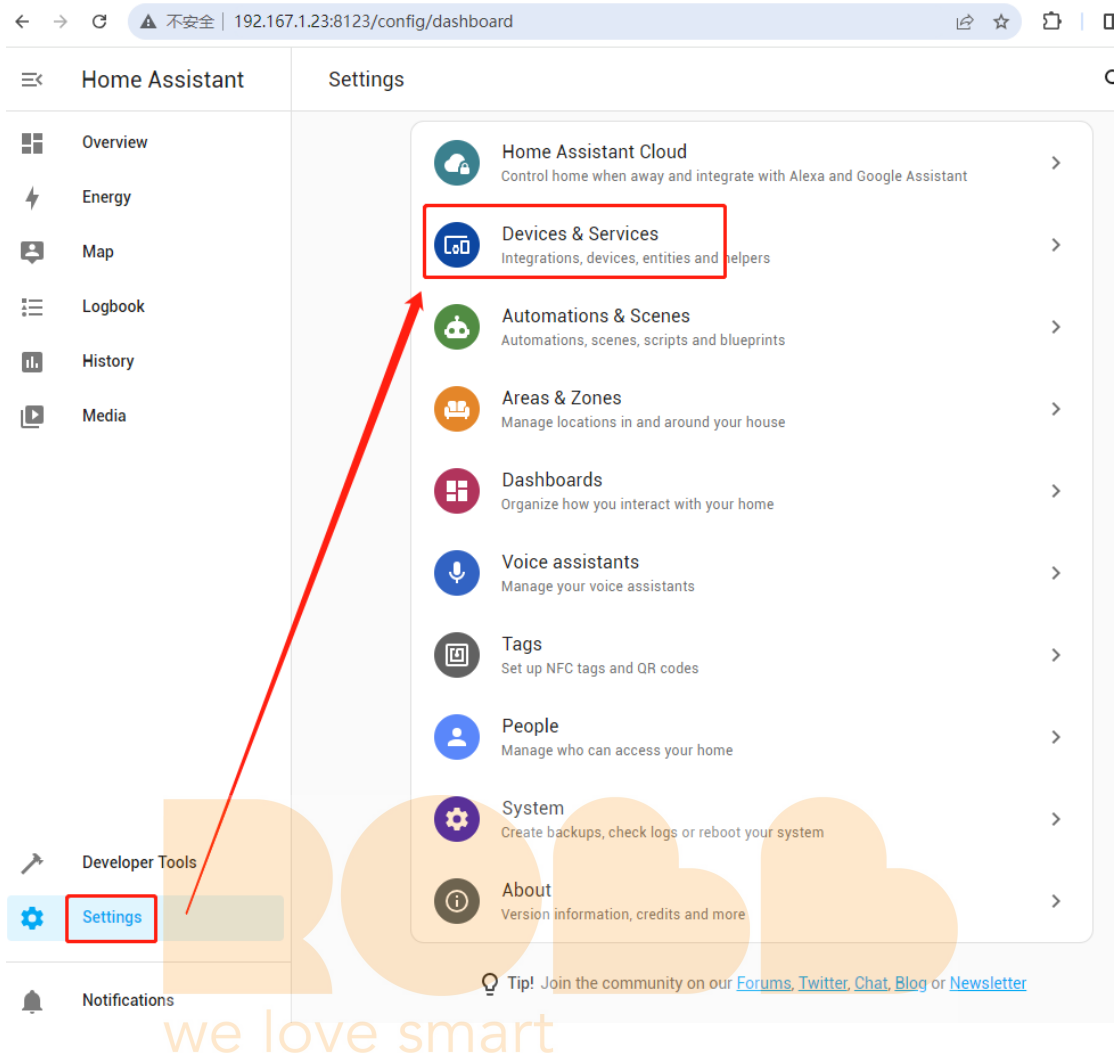

Step 2: In Integrations, click + ADD INTEGRATION button, as shown below:

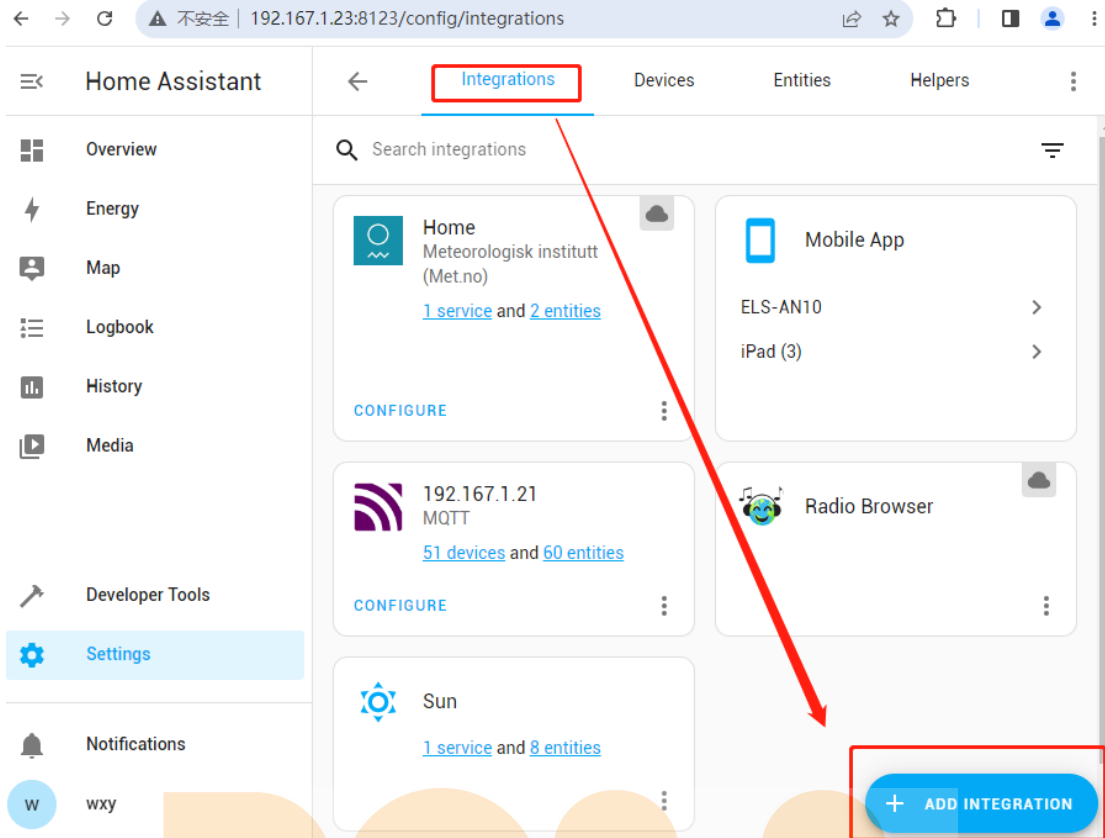

Step 3: In the pop-up dialog box, enter MQTT in the Search for a brand name input box, then select MQTT, as shown below:

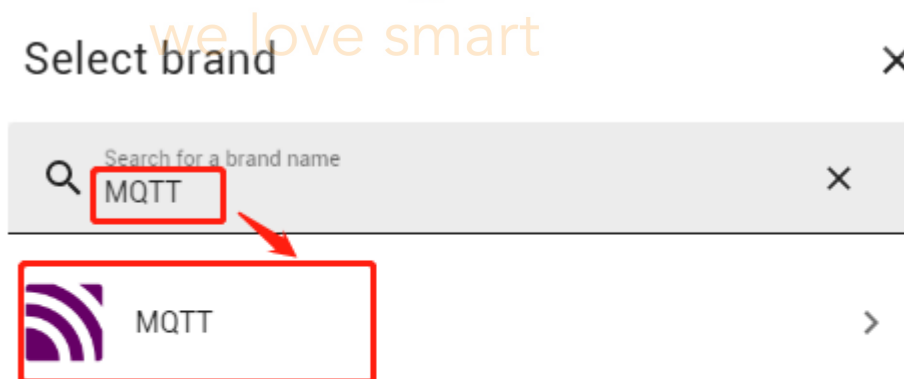

Step 4: Continue to select MQTT, as shown below:

< What do you want to add?

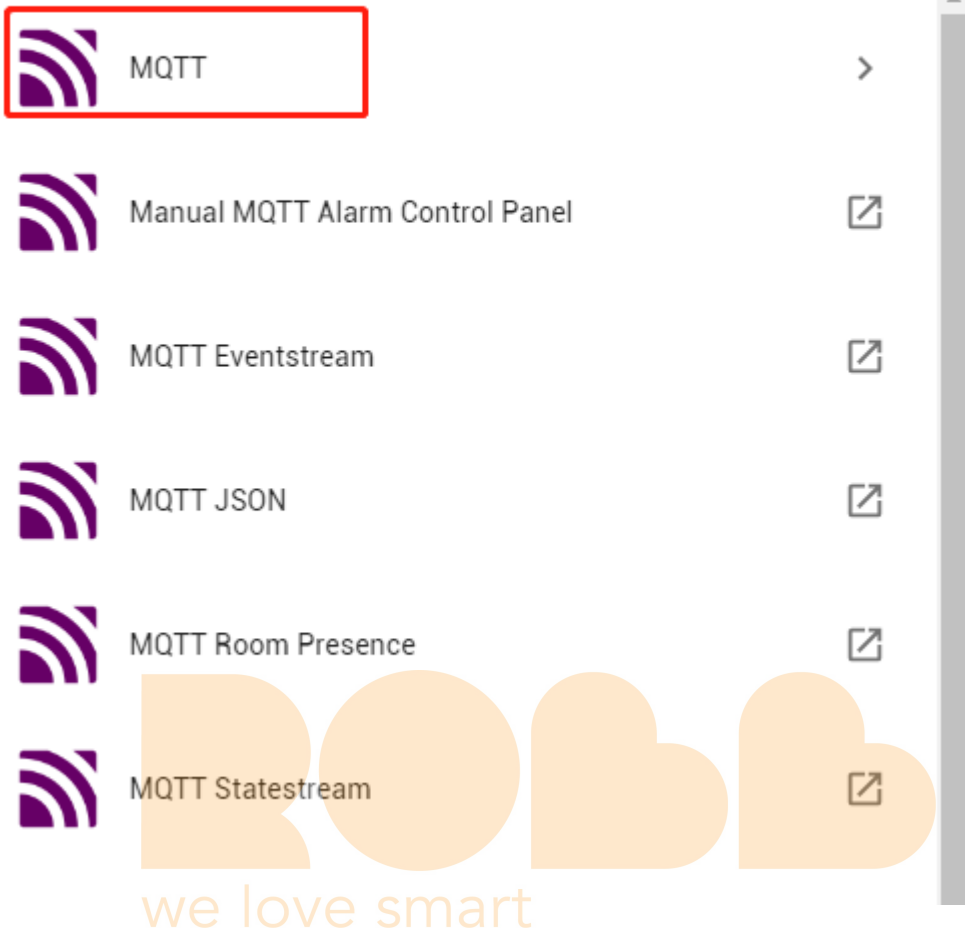

Step 5: Enter the information for the MQTT Broker, and click SUBMIT button to finish the configuration, as shown below:

MQTT

Please enter the connection information of your MQTT broker.

Broker*
192.167.1.21

Port*
1883

Username
sDiOzHFCKLxFITkPcvlCvUKxIWFtla

Password
.....

Advanced options

we love smart

SUBMIT

The MQTT Broker can be self-installed by the user or purchased from a cloud service provider. In addition, since the gateway comes with an MQTT Broker, you can also directly enter the information of the gateway's MQTT Broker here. The following describes how to obtain the information of the gateway's MQTT Broker.

Enter the Azoula Smart App and select Me - Settings, as shown below:

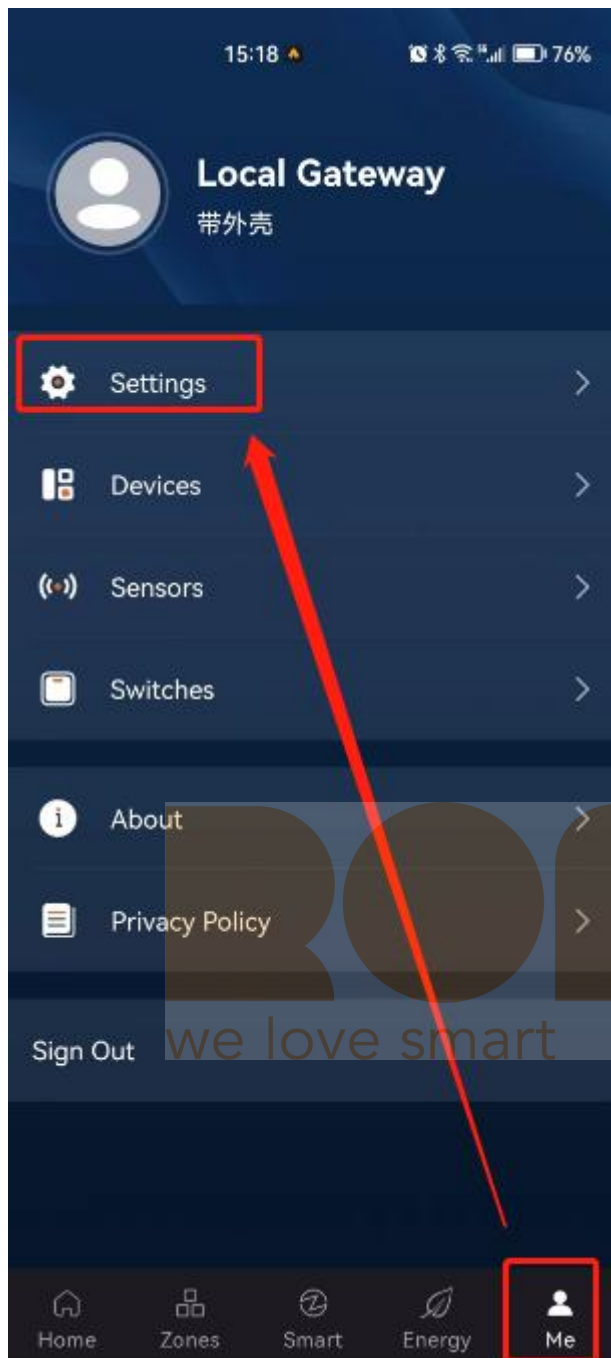

Select LAN MQTT, as shown below:

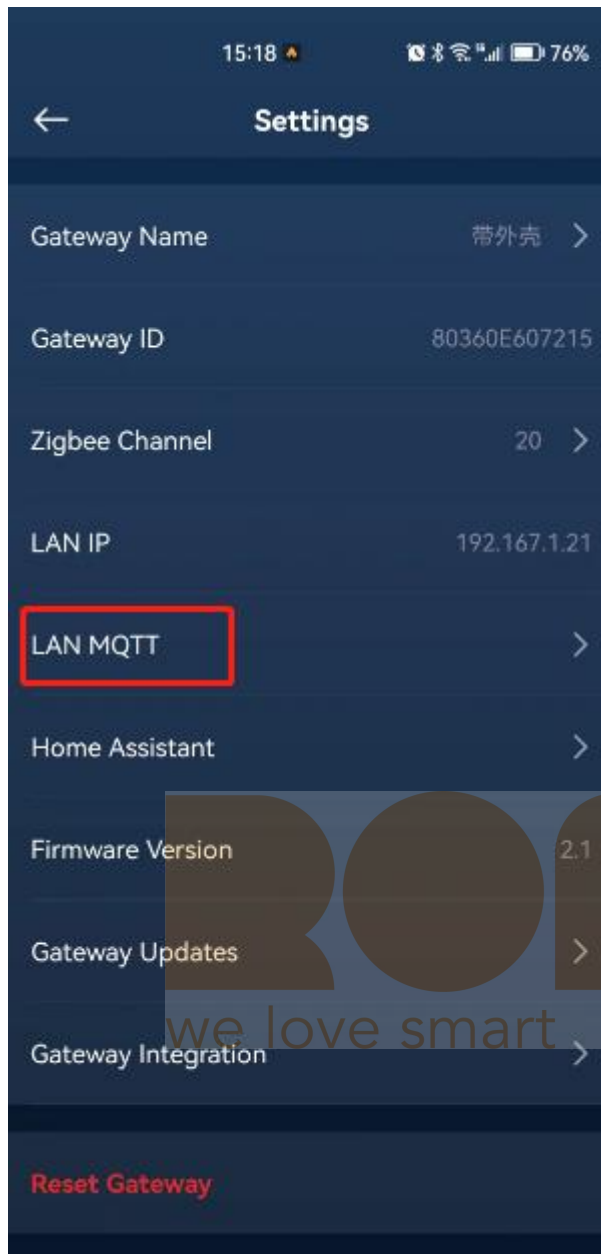

The pop-up window displays the gateway's MQTT Broker information. You can enter the IP address, Username, and Password of the MQTT here in the above Step 5.

15:18

76%



Settings

Gateway Name

带外壳 >

Gateway ID

80360E607215

Zig

LA

LA

Ho

Fi

Ga

Gateway Integration >

Reset Gateway

LAN MQTT



IP

192.167.1.21



Username

sDiOzHFCKLxFITkPcvICvUKxIWft!
a we love smart



Password

LyoYPIX8nBJcIIN3dCKST!OJrV5SF9



If you enter the information of a self-installed or purchased MQTT Broker in Step 5, further configuration is required to connect the gateway to this MQTT. The steps are as follows:

Enter the Azoula Smart App and select Me - Settings, as shown below:

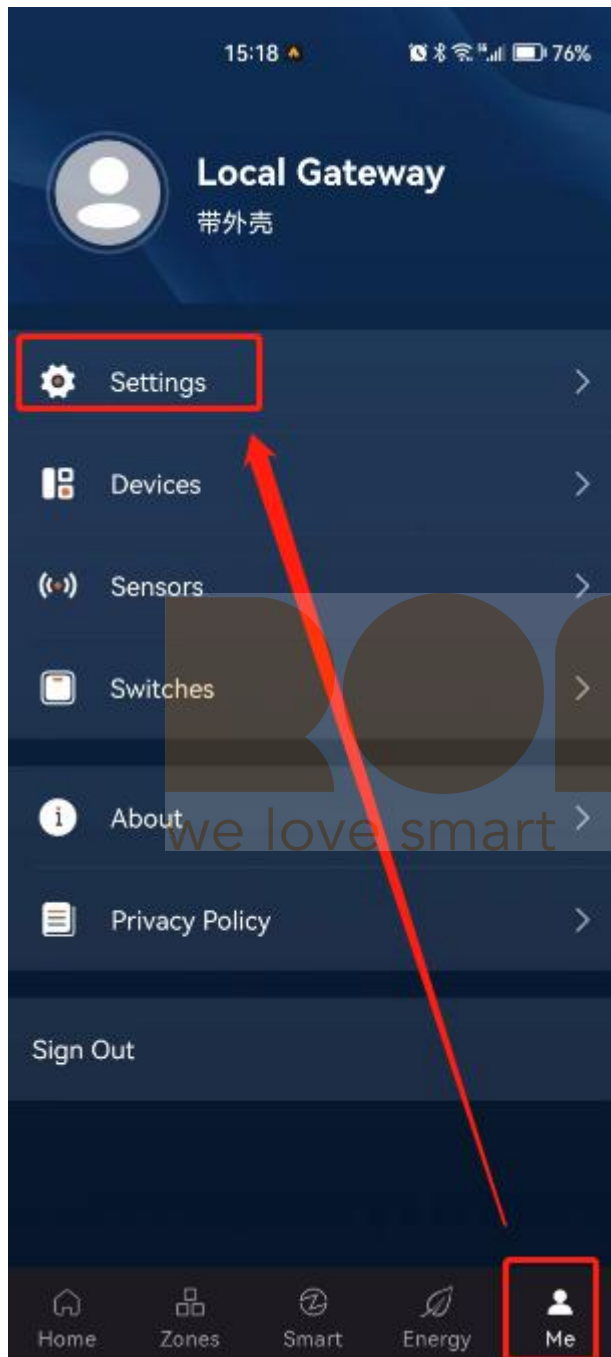

Select Home Assistant, as shown below:

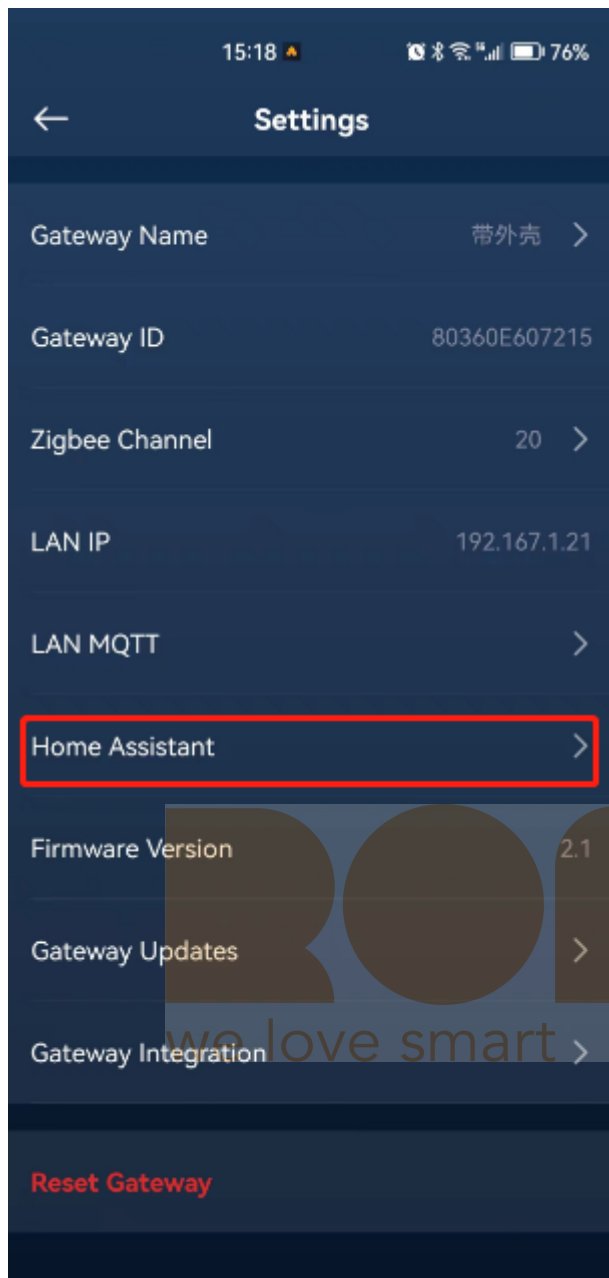

In the pop-up window, change the MQTT Mode to Client, enter the MQTT Broker information, choose the language for Home Assistant, and click Save to save the settings.

15:52

75%



Home Assistant

Save

MQTT Mode

Client



This gateway will connect to the server.

Client ID

* Host

* Port

* Username

* Password

MQTT Transfer

tcp



Language

English

