

meross

User Manual

Package Contents



1 x Smart Garage Door Opener



1 x USB Adapter
and Cable



4 x Screws



1 x Test Wire

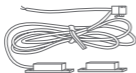

1 x Cable

(23-feet or 7m door sensor cable and
11.9-inch or 30cm signal control cable)



1 x Double-sided
Adhesive Tapes



1 x Cable Tie

* If you find any part is missing in the package, please contact support@meross.com, we will provide proper solution for you.

Installation Guide

1. Meross smart garage door opener is the companion device of your existing garage door opener. It supports up to 3 garage doors. Its main working principle is as follows.

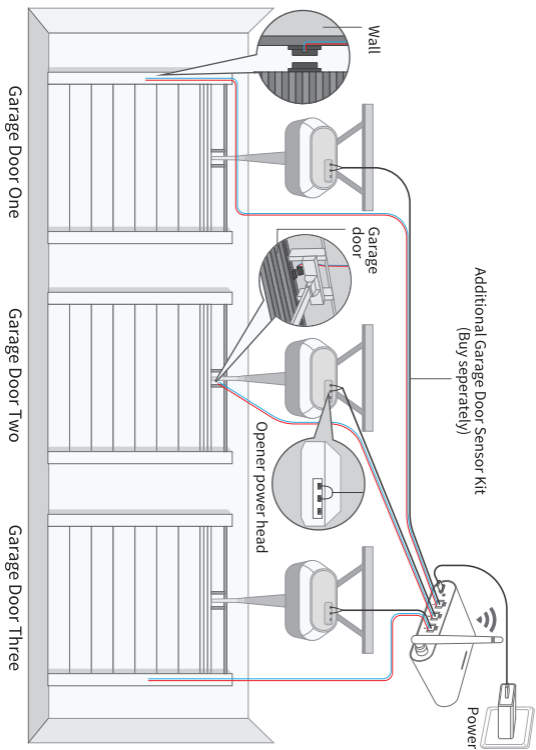

2. Download the Meross app and choose Smart Garage Door Opener to get start.



3. Power on the device. Wait about 5 seconds until the status LED blinks amber and green.

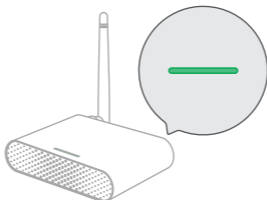

4. Connect the device to your home WiFi with Meross app.

5. Choose how many garage doors are you going to setup in the app wizard, it can help activate the ports automatically. You can activate/inactivate extra port any time after the configuration.



Single Door



Two Single Doors

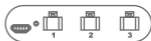

Three Single Doors

6. Connect the sensor cable. Move the sensor to check if it is functional*. Make sure the cable is connected to the activated port.



*Please contact support@meross.com for help if the sensor is not functional.

7. Find a proper position on the garage door to mount the sensors*. Please make sure the distance between the two sensors is less than 1 inch when the garage door is closed, and the two sensors are well separated when the garage door is open.

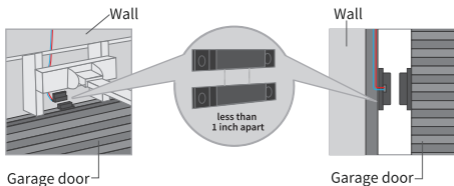

*You can use the included double-sided adhesive tapes or screws for sensor fixation.

8. Power OFF both existing garage door opener and your smart device. Connect the signal control cable to the two terminals that connects to the wall button. Wire order does not matter here.

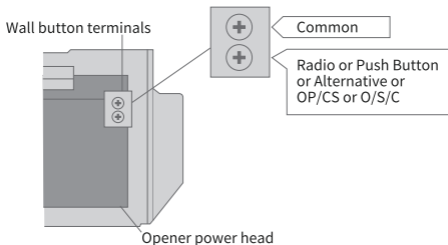

- 9. Deploy the device. We recommend to deploy it on the top of your existing garage door opener and if you have three single doors, please deploy the device on the middle door opener. Use the provided double-sided adhesive tapes for the fixation if necessary.**

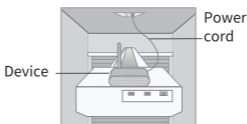

- 10. If you have two or three single doors*, please repeat step 6 - 8 to finish the setup.**

*Additional garage door sensor kit is required for the second or third single door.

- 11. Power on both existing garage door opener and smart garage door opener. The smart garage door opener will reconnect to Meross cloud service automatically. Congratulations! You have completed all installation steps.**

LED and Button Rules

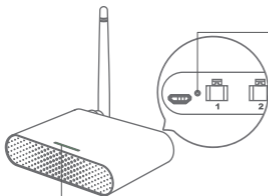

Reset Button

Hold for 5 seconds to enter Wi-Fi configuration mode.

Status LED

Solid amber: Initialization/ Reset/ Firmware upgrading mode.

Flashing amber and green slowly: Configuration mode.

Flashing green rapidly: Wi-Fi connecting mode.

Solid green: Successfully connected.

Solid red: No internet connection.

Flashing amber once: Sensors connected or disconnected (Door close or open detected).

Off: Power OFF.

How to Use

1. General Settings



Port 1/2/3:

Activate/Inactivate doors, and configure individual garage settings.

LED: Turn on/off LED.

User manual: Check user manual

2. Port Settings



Garage door name:

Change garage name.

Garage door status:

Activate or inactivate this garage door.

Operation history: Check operation history of this garage door.

Door notification

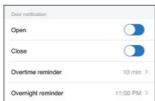

Open:

Send me a notification each time my garage door opens.

Close:

Send me a notification each time my garage door closes.

Overtime reminder:

Send me a notification when my garage door opens for 10-60 mins.

Overnight reminder:

Send me a notification when my garage door is still open after particular time.

Auto close & Advance settings

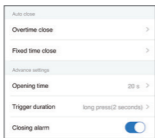

Overtime close:

Close the door automatically when the door opens for a period of time.

Fixed time close:

Close the door automatically when the door is still open after particular time.

Opening time:

Choose the proper time duration for your garage door opener. App use it as a timeout parameter to confirm the status of your garage.

Trigger Duration:

Choose the proper trigger duration if you find your meross app can't fully close or open your garage door. The trigger duration is the same time as you press the garage wall button.

Closing alarm:

Sound alarm when door is closing.

3. Voice Control

Amazon Alexa



Meross provides two types of voice commands for Amazon Alexa. If you Choose “Meross” skill, the commands are as following:

- “Hi Alexa, open/close my garage.”
- “Hi Alexa, lock/unlock my garage.”
- “Hi Alexa, is my garage locked/closed?”

Google Assistant:



Choose “meross” action, the commands are as following:

- “Hey Google, open/close garage door.”
- “Can I have your security code?”
- “Hey google, is garage door opened/closed?”

Note: 1. Please replace ‘garage door ‘ to the garage door name you set.
2. PIN code is required to set by google for security concern.

4. Widgets

Widgets are the quick access to your Meross devices and Scenes. To enable it, please go to **Account -> Widget** to add shortcuts first. And then follow below steps on your smartphones to activate them.



For iPhones:

1. Swipe to the right on your Home or Lock screen.
2. Scroll down to the bottom of your widget list and then tap edit.
3. Scroll down to find Meross and add it.

For Android smartphones:

1. On the home screen, tap and hold on an available space.
2. Tap Widgets, find Meross widget and then add it.

FAQ

At Meross we strive to assure your satisfaction. Any questions about Smart Garage Door Opener please feel free to contact support@meross.com.

1. Is Meross MSG100 compatible with my garage door opener? Do I need accessory?

Go to www.meross.com/compatibility and choose your brand/model. If your model is not listed or need accessory to make it work, please email below things to support@meross.com.

- (1) Your order id.
- (2) Learn button color of your garage door opener.
- (3) Your opener brand and model.
- (4) An address for the accessory shipment.

2. Why I can open or close my garage door, but meross app shows wrong status?

Probably your sensor is not well installed or the sensor is defective. You can follow below points to troubleshoot:

- (1) Manually move the two sensor parts close (less than 1/4 inch) or apart, to check whether the meross app updates the right status.
- (2) Make sure the sensor cables are well connected to the smart device. If you disconnect the sensor wire, the device is in door open status. Please try to short the two pins in red connector, the device is in door close status.

3. What shall I do when my Meross app is unable to control the added smart garage door opener?

Please check the followings:

- Check the main Wi-Fi's internet connection.
- Make sure that main Wi-Fi's password hasn't been changed.
- Factory reset the device and try to configure its Wi-Fi part again.

Warranty

Meross products are covered by a 12 months limited warranty from the date of its original purchase. If any problems occur, please contact support@meross.com for help.

We can only provide aftersales service for products that are sold by Meross or Meross authorized retailers and distributors.

SIMPLE DEVICE SIMPLIFY YOUR LIFE

Email: support@meross.com

Website: www.meross.com

Designed in California. Made in China

Supervisor: MRTECH USA Limited

Address: 8825 53 Ave, Elmhurst, NY 11373, USA

Manufacturer: Chengdu Meross Technology Co., Ltd.

Address: No. 1312, Building E6-1, Tianfu Software Park, Chengdu, China



Libelle Consulting GmbH

Hoferstraße 9B, 71636 Ludwigsburg, Baden-Württemberg,
Deutschland

Made in China

