

Smart Siren

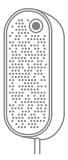

INSTALLATION MANUAL

Version 1.2

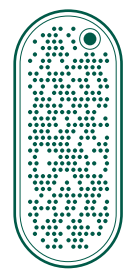

Product description

The Smart Siren emits an alarm sound and sends a notification if intruders, burglars, or other unwanted guests enter the property.

The Smart Siren includes a voice prompt and functions as a range extender for Zigbee networks. The Smart Siren has a battery backup, so it will still be able to function in case of a power cut.

Precautions

- **WARNING:** For safety reasons, always make sure to disconnect the Smart Siren from the power socket before removing the front cover.
- Do not remove the product label as it contains important information.
- Be aware that electronics are sensitive to static electricity, so aim to discharge before touching, and avoid touching any components inside the device.
- Do not paint the device.

- Leaving a battery in an extremely high temperature surrounding environment that can result in an explosion or the leakage of flammable liquid or gas.
- A battery subjected to extremely low air pressure that may result in an explosion or the leakage of flammable liquid or gas.
- The socket-outlet shall be installed near the equipment and shall be easily accessible.

Placement

PLACE THE SIREN

- Indoors at a temperature between 0-50°C.
- On a wall, where it is reachable for maintenance.

Getting started

1. Open the casing of the device by removing the screw at the bottom of the device.

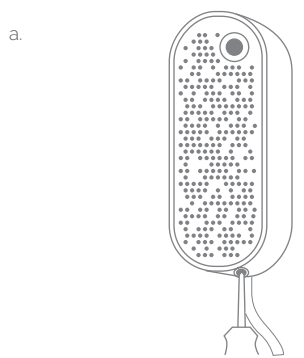

2. Use the included screws to mount the siren on the wall.

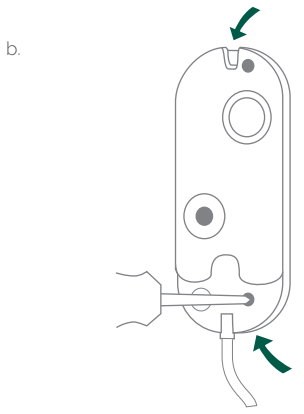

3. Attach the front cover to the device by hooking the front cover to the top of the mounted device and pushing the front cover against the device.

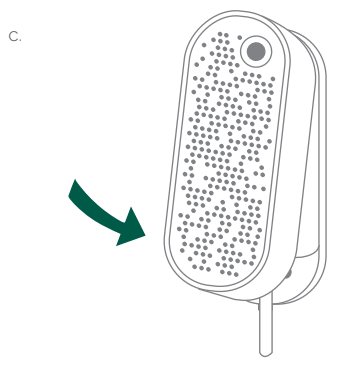

4. Insert a screw at the bottom of the device.

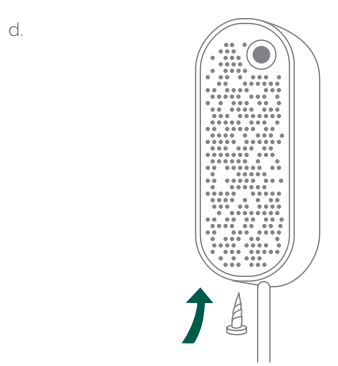

5. Insert the plug of the cable attached to the Smart Siren into a power socket.

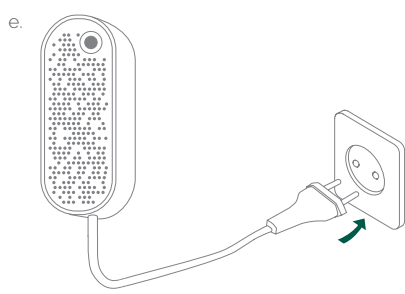

6. When the device is powered up, the Smart Siren will start searching (up to 15 minutes) for a Zigbee network to join. While the siren is searching for a Zigbee network to join, the yellow LED flashes.
7. Make sure that the Zigbee network is open for joining devices and will accept the siren.
8. When the LED stops flashing, the siren has successfully joined the Zigbee network.
9. If the scanning has timed out, a short press on the menu button will restart it.

ALTERNATIVE INSTALLATION OPTION

Another installation option is to replace the included cable with an alternative cable. If the installation consists of an in-wall cable, drill a hole in the marked area, through which the cable needs to be inserted, and connect the cable to the Smart Siren.

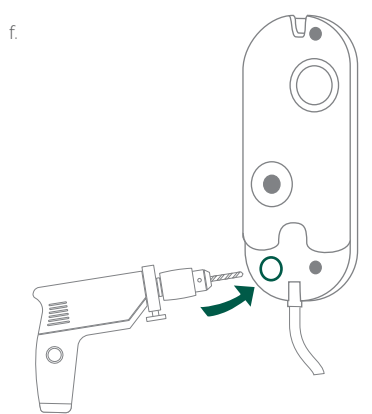

Resetting

Resetting is needed if you want to connect your Smart Siren to another gateway or if you need to perform a factory reset to avoid abnormal behavior.

STEPS FOR RESETTNG

1. Connect the Smart Siren to a power outlet.
2. Press and hold the menu button the device.

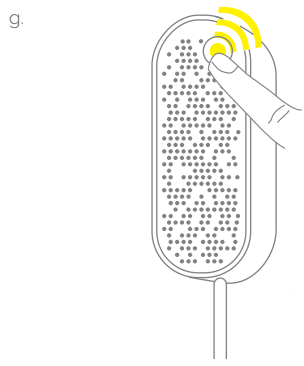

3. While you are holding the button down, the yellow LED first flashes once, then two times in a row, and finally numerous times in a row.
4. Release the button while the LED is flashing numerous times in a row.
5. After you release the button, the LED shows one long flash, and the reset is completed.

Modes

SEARCHING GATEWAY MODE

The yellow LED flashes

MAINS POWERED

The green LED is on

BATTERY BACKUP (MAINS FAILURE)

The green LED flashes. This means that there is a mains failure, e.g. due to a power outage, and the device runs on battery for up to 14 hours.

Fault finding and cleaning

- In case of a bad or wireless weak signal, change the location of the Smart Siren. Otherwise, you can relocate your gateway or strengthen the signal with a smart plug.
- If the search for a gateway has timed out, a short press on the button will restart it.

Disposal

Dispose the product properly at the end of its life. This is electronic waste which should be recycled.

Disposal of a battery into fire or a hot oven, or mechanically crushing or cutting of a battery, that can result in an explosion.

CE certification

The CE mark affixed to this product confirms its compliance with the European Directives which apply to the product and, in particular, its compliance with the harmonized standards and specifications.



IN ACCORDANCE WITH THE DIRECTIVES

- Radio Equipment Directive (RED)
2014/53/EU
- RoHS Directive 2015/863/EU amending
2011/65/EU

Other certifications

Zigbee 3.0 certified



All rights reserved.

frient assumes no responsibility for any errors, which may appear in this manual. Furthermore, frient reserves the right to alter the hardware, software, and/or specifications detailed herein at any time without notice, and frient does not make any commitment to update the information contained herein. All the trademarks listed herein are owned by their respective owners.

Distributed by frient A/S
Tangen 6
8200 Aarhus
Denmark
www.frient.com

frient®