

SwitchBot Water Leak Detector

User Manual



www.switch-bot.com
V1.4-2403

Please read this user manual carefully before
using your device.

Scannen Sie den QR-Code, um die deutsche Version
unseres Benutzerhandbuchs zu erhalten.

Scannez le code QR pour obtenir notre manuel
d'utilisation en version française.

Escanee el código QR para obtener la versión en
español de nuestro manual de usuario.

Scan de QR code voor de Nederlandse versie van
onze gebruikershandleiding.

Scansionate il codice QR per ottenere la versione
italiana del nostro manuale d'uso.

[https://www.switch-bot.com/
pages/switchbot-user-manual](https://www.switch-bot.com/pages/switchbot-user-manual)



User Manual

Contents

| | |
|----------------------------------|----|
| List of Components | 01 |
| Package Contents | 03 |
| Preparation | 04 |
| Installation | 05 |
| LED Indicator Light | 13 |
| Battery Replacement | 14 |
| Resetting Factory Settings | 15 |
| Firmware Upgrades | 16 |
| Frequently Asked Questions | 17 |
| Specifications | 19 |
| Warranty | 20 |
| Contact & Support | 22 |

List of Components

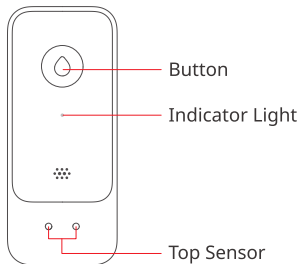
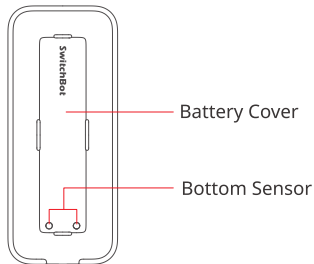

Indicator Light: shows device status.

Top Sensor: detects water droplets.

Button: used for pairing, testing and muting alarm sounds.

Bottom Sensor: detects water leaks.

Package Contents



Water Leak Detector
× 1



AAA Battery × 2



Triangle Opener × 1

Preparation

You will need:

- A smartphone or tablet using Bluetooth 4.2 or later.
- The latest version of our app, downloadable via the Apple App Store or Google Play Store.
- A SwitchBot account, you can register via our app or sign in to your account directly if you already have one.



iOS 14.0+



Android OS 5.0+

Installation

Remove the Battery Cover

Use the Triangle Opener provided to open the Battery Cover.

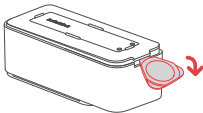

Install batteries and test your device

① Insert the batteries into the battery slot, ensuring they are in the right direction.

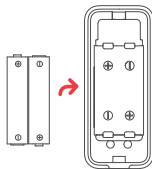

AAA battery × 2

② Align and close the battery cover.

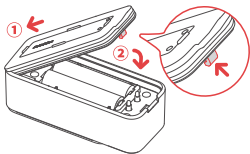

③ Press the button. If the Buzzer beeps and the Indicator Light flashes twice, your Water Leak Detector is now working normally.

Press the
button once.

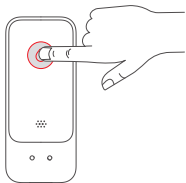

Add to the SwitchBot app

Open our app, tap the "+" icon located in the right-hand corner of the home page, and select Add Device.

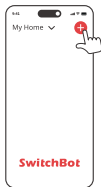

- Our app is regularly updated. Follow the in-app instructions to add your device.
- Registering an account or adding a device will not compromise your privacy, data is only for ensuring normal use of your device.

Position the water detector

Lay the device where water leak monitoring is needed and ensure it would come into contact with leaking water.



Water leak/drip detection

When the water detector detects leaks, it will generate continuous sound alarms to alert you, and our app will send a water leak notification to your smartphone.

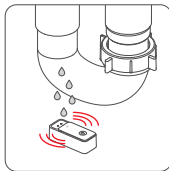

Drip alarms

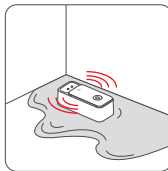

Leak alarms

Please note: If water leaks are not handled after a sound alarm session, the device will emit sound alarms again. A sound alarm session lasts 5 minutes by default. You can change the duration setting on our app.

Mute alarms

After you press the device button when a sound alarm is triggered, the alarm will mute for 5 minutes and continue alerting if the alarm persists 5 minutes later.

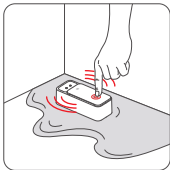

Clear alarms

Take the device out of water and dry it. The alarm will be cleared and our app will send you a notification.

App settings

On the device page of our app, you can view device status and messages regarding your water detector. You can also set alarm duration, alarm sound interval and alarm volume.

Voice reminders

For details about how to customize voice reminders, scan this QR code please.



LED Indicator Light

| LED Indicator Light | Description |
|--------------------------------------|-------------------|
| ○ Flashes white once | Powering on |
| ○ Fast flashes white for 120 seconds | In pairing mode |
| ○ Fast flashes white for 15 seconds | Device restarting |
| ● Fast flashes red | Alarm triggered |
| ● Flashes red 2 times | Device testing |

Battery Replacement

When your device's battery is low, our app will send a low battery notification. Replace batteries as described below:

1. Use the provided tool to open the battery cover (After replacement, ensure the cover is tightly closed for a better waterproof effect.)
2. Replace the batteries with new ones and test your detector.

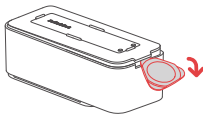

Resetting Factory Settings

Press and hold the button for 15 seconds, then release it. The Indicator Light will stay on for 2 seconds and the Buzzer will sound for 2 seconds, which means your device has been restored to its default factory settings.

Firmware Upgrades

In order to improve user experience, we will regularly release firmware updates to introduce new functions and solve any software defects that may occur during usage. When a new firmware version is available, we will send an upgrade notification to your account via our app. When upgrading, please make sure your product has sufficient battery and make sure your smartphone is within range to prevent interference.

Frequently Asked Questions

Q: My water detector doesn't work properly, why?

A:

- 1) Check whether the batteries are installed correctly.
- 2) Check device battery level.

Q: My device failed to connect to Wi-Fi, or the connection is unstable, what can I do?

A:

- 1) Make sure you are using a 2.4 GHz Wi-Fi network.
- 2) Check whether your Wi-Fi name and password are entered correctly.
- 3) Make sure your device is within range of router signals.

Q: My SwitchBot app does not send notifications, or there is a delay in app notifications, is this normal?

A:

- 1) Make sure you have enabled device notifications via our app.
- 2) Check your home network's quality and whether the device is within Wi-Fi range.

Please visit our website or scan the QR code below for more information.

<https://support.switch-bot.com/hc/en-us/categories/18722423710231>



Specifications

Color: White

Material: ABS

Size: 78 × 29 × 32 mm (3.1 × 1.1 × 1.3 in.)

Weight: 68 g (2.4 oz.)

Water Resistance: IP67

Noise: 100 dB

Power: 2 × AAA battery

Battery Life: Approx. 2 years

Operating Temperature:

0 °C to 40 °C (32 °F to 140 °F)

Operating Humidity: 0% to 99% RH

Connectivity:

Wi-Fi 2.4 GHz + BLE 4.2 or above

System Requirements:

iOS 14.0 +, Android OS 5.0 +

Warranty

We warrant to the original owner of the product that the product will be free from defects in materials and workmanship. Please note that this limited warranty does not cover:

1. Products submitted beyond the original limited warranty period.
2. Products on which repairs or modifying have been attempted.
3. Products subjected to falls, extreme temperatures, water, or other operating conditions outside the product specifications.
4. Damage due to natural disaster (including but not limited to lightning, flood, tornado, earthquake, or hurricane, etc.).

5. Damage due to misuse, abuse, negligence or casualty (e.g. fire).
6. Other damage that is not attributable to defects in the manufacture of product materials.
7. Products purchased from unauthorized resellers.
8. Consumable parts (including but not limited to batteries).
9. Natural wear of the product.

Contact & Support

Feedback: If you have any concerns or problems when using our products, please send feedback via our app through the Profile > Help & Feedback page.

Setup and Troubleshooting:
support.switch-bot.com

Support Email:
support@switch-bot.com

CE Warning

To comply with RF exposure requirements, a minimum separation distance of 20 cm must be maintained between the user's body and the device, including the antenna. Use only the supplied or an approved antenna. This device is in compliance with the essential requirements and other relevant provisions of directive 2014/53/EU. All essential radio test suites have been carried out.

CE DOC

Hereby, Woan Technology (Shenzhen) Co., Ltd. declares that the radio equipment typ (W4402000) is in compliance with Directive 2014/53/EU. The full text of the EU declaration of conformity is available at the following internet address:

support.switch-bot.com

This product can be used in EU member states and UK.

Manufacturer: Woan Technology (Shenzhen) Co., Ltd.
Address: Room 1101, Qiancheng Commercial Center,
No. 5 Haicheng Road, Mabu Community, Xixiang
Subdistrict, Bao'an District, Shenzhen, Guangdong,
P.R.China, 518100

CE representative: XDH Tech

Address: 2 Rue Coysevox Bureau 3, Lyon, France

Operation frequency

Wi-Fi: 2412 MHz to 2472 MHz

BLE: 2402 MHz to 2480 MHz

Operation temperature: 0 to 40 °C

FCC Warning

This device complies with Part 15 of the FCC Rules. Operation is subject to the following two conditions:

- (1) This device may not cause harmful interference.
- (2) This device must accept any interference received, including interference that may cause undesired operation.

NOTE: This equipment has been tested and found to comply with the limits for a Class B digital device, pursuant to part 15 of the FCC Rules. These limits are designed to provide reasonable protection against harmful interference in a residential installation.

This equipment generates uses and can radiate radio frequency energy and, if not installed and used in accordance with the instructions, may cause harmful interference to radio communications. However, there is no guarantee that interference will not occur in a particular installation. If this equipment does cause harmful interference to radio or

television reception, which can be determined by turning the equipment off and on, the user is encouraged to try to correct the interference by one or more of the following measures:

- Reorient or relocate the receiving antenna.
- Increase the separation between the equipment and receiver.
- Connect the equipment into an outlet on a circuit different from that to which the receiver is connected.
- Consult the dealer or an experienced radio/TV technician for help.

NOTE: The manufacturer is not responsible for any radio or TV interference caused by unauthorized modifications to this equipment. Such modifications could void the user's authority to operate the equipment.

FCC Radiation Exposure Statement

The device has been evaluated to meet general RF exposure requirement. The device can be used in portable exposure condition without restriction.

IC Warning

This device contains license-exempt transmitter(s)/ receiver(s) that comply with Innovation, Science and Economic Development Canada's license-exempt RSS(s). Operation is subject to the following two conditions:

- (1) This device may not cause interference.
- (2) This device must accept any interference, including interference that may cause undesired operation of the device.

IC Radiation Exposure Statement

This equipment complies with the IC radiation exposure limits established for uncontrolled environment. This equipment must be installed and operated at least 20 cm from a radiator or your body. Cet équipement est conforme aux limites d'exposition aux rayonnements de la IC établies pour un environnement non contrôlé. Cet équipement doit être ins.