



GLEDOPTO

INDOOR PRODUCT PRO

User Instruction



Overview

This series of downlights that can be controlled using HUE, SmartThings, Tuya and other Zigbee gateways. It can also be paired with an RF remote control to adjust the down lights color, color temperature, and brightness.

Use gateway connection

1. Connect the power supply of the ultra-thin tube light correctly.
2. Use the gateway's app to start device search. Wait for a certain period of time (see the instructions of each gateway for details). If the gateway cannot find the ultra-thin down light light, try to power it on again or reset the light.
3. After the gateway finds the ultra-thin down light, add the light to the designated room or group.
4. The setup is complete, and the light can be used.

Compatible with gateway

The product works with many ZigBee 3.0 Gateways like Philips Hue, Amazon Echo Plus or SmartThings.



Use RF remote control to connect

Pairing:

1. Power on the ultra-thin down light light (within 4 seconds, perform the next operation).
2. Press any "on" button on the RF remote control (see the instructions of each remote control for details).
3. When the ultra-thin down light gets green, it means that the connection with the remote control is successful.

Compatible 2.4G RF Remote Control



GL-RC-006Z



GL-RC-009



GL-W-001Z

Reset:

1. As shown in Figure 1:

1. Power on the ultra-thin down light.
2. Turn off the power within 2 seconds.
3. Wait for more than 5 seconds to ensure that it is completely powered off.
4. Repeat the above steps 5 times.
5. The ultra-thin down light will flash 3 times, indicating that the reset is complete.



RGB+CCT Downlight

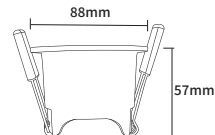

(GL-D-001P)

Power: 6W
Input voltage: AC 100~240V
CRI: >80
Light efficiency: 70LM/W
Luminous Flux: 350~450LM
Beam angle: 60°
Color temperature: 2200~6500K
Material: Aluminum+PC Cover
Hole size: 78mm(3.07in)
Lifespan: 50000hours

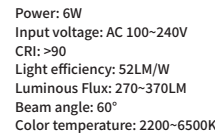

(GL-D-002P)

Power: 6W
Input voltage: AC 100~240V
CRI: >90
Light efficiency: 52LM/W
Luminous Flux: 270~370LM
Beam angle: 60°
Color temperature: 2200~6500K
Material: Aluminum+PC Cover
Hole size: 61mm(2.40in)
Lifespan: 50000hours

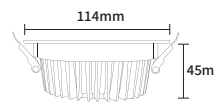

(GL-D-003P)

Power: 6W
Input voltage: AC 100~240V
CRI: >80
Light efficiency: 95LM/W
Luminous Flux: 470~570LM
Beam angle: 120°
Color temperature: 2200~6500K
Material: Aluminum+PC Cover
Hole size: 104mm(4.09in)
Lifespan: 50000hours

Power: 9W
Input voltage: AC 100~240V
CRI: >80
Light efficiency: 85LM/W
Luminous Flux: 600~750LM
Beam angle: 120°
Color temperature: 2200~6500K
Material: Aluminum+PC Cover
Hole size: 104mm(4.09in)
Lifespan: 50000hours

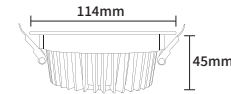

(GL-D-004P)

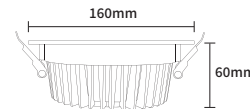

(GL-D-005P)

Power: 12W
Input voltage: AC 100~240V
CRI: >80
Light efficiency: 100LM/W
Luminous Flux: 1000~1200LM
Beam angle: 120°
Color temperature: 2200~6500K
Material: Aluminum+PC Cover
Hole size: 150mm(5.9in)
Lifespan: 50000hours

Power: 6W
Input voltage: AC 100~240V
CRI: >80
Light efficiency: 60LM/W
Luminous Flux: 280~350LM
Beam angle: 60°
Color temperature: 2200~6500K
Material: Aluminum+PC Cover
Hole size: 83mm(3.26in)
Lifespan: 50000hours

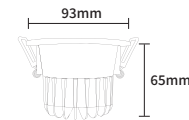

(GL-D-006P)

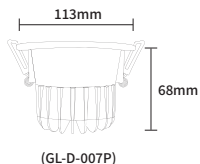

(GL-D-007P)

Power: 12W
 Input voltage: AC 100~240V
 CRI: >80
 Light efficiency: 67LM/W
 Luminous Flux: 660~680LM
 Beam angle: 60°
 Color temperature: 2200~6500K
 Material: Aluminum+PC Cover
 Hole size: 103mm(4.05in)
 Lifespan: 50000hours

Power: 12W
 Input voltage: AC 100~240V
 CRI: >80/>90
 Light efficiency: 100LM/W
 Luminous Flux: 660~800LM
 Beam angle: 60°
 Color temperature: 2200~6500K
 Material: Aluminum+PC Cover
 Hole size: 92mm(3.62in)
 Lifespan: 50000hours

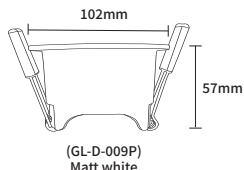

(GL-D-009P)
 Matt white

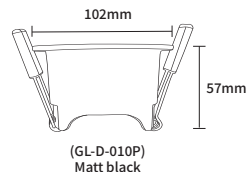

(GL-D-010P)
 Matt black

Power: 12W
 Input voltage: AC 100~240V
 CRI: >80/>90
 Light efficiency: 100LM/W
 Luminous Flux: 660~800LM
 Beam angle: 60°
 Color temperature: 2200~6500K
 Material: Aluminum+PC Cover
 Hole size: 92mm(3.62in)
 Lifespan: 50000hours

Note: The dimensions of the above holes are measured manually,
 Please refer to the actual objects.

Installation Steps

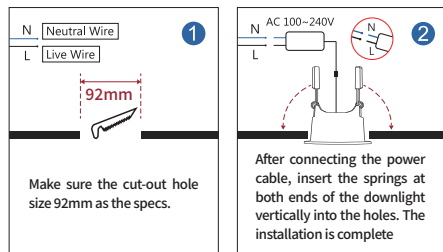

Note: All the downlights are recessed mounting as same as the above,
 but it's different cut-out hole size according to the specs sheet.

RGB+CCT Downlight E26

Power: 9W
 Input voltage: AC 100~240V
 CRI: >80
 Light efficiency: 76LM/W
 Luminous Flux: 580~700LM
 Beam angle: 120°
 Color temperature: 2200~6500K
 Material: Aluminum+PC Cover
 Hole size: 153mm
 Lifespan: 50000hours

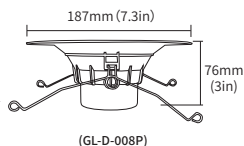

(GL-D-008P)

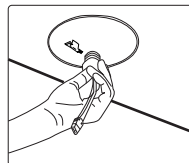

Step 1: Insure power is off,
 Remove bulb and trim ring.
 Screw base adapter in to socket.

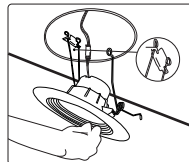

Step 3: Squeeze torsion springs
 together and release inside of
 C clips for both sides.

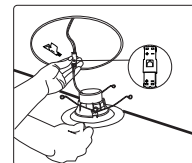

Step 2: Connect downlight to
 adapter using the orange
 connector.

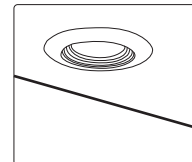

Step 4: Push up the downlight
 until the trim is flush with ceiling.
 Ensure no wires are exposed.



LED-Trading Tobias Ebert
 Schoeneicher Str. 42, Schoeneiche b. Berlin, Germany, 15566
 0049 30 641 689 17 info@led-trading.de

Compability Chart

Gateways	Philips Hue	Amazon Echo Plus	Smart Things	Tuya	Conbee	Homey	Homee
Item	①	②	③	④	⑤	⑥	⑦
RGB	Yes	Yes	Yes	Yes	Yes	Yes	Yes
CCT	Yes	Yes	Yes	Yes	Yes	Yes	NO
BRIGHTNESS	Yes	Yes	Yes	Yes	Yes	Yes	Yes



①②③④⑤⑥ are already tested by GLEDOPTO, ⑦ are from our
 customers, just for your information, not verified by GLEDOPTO.



- ATTENTION**
1. Use the product under the rated voltage. Overvoltage or undervoltage usage may cause damage.
 2. Non-professional users cannot directly disassemble the product, otherwise it may cause fire or electric shock.
 3. The working temperature is -20~45°C. Do not use the product in areas with direct sunlight, humidity, high temperature, etc.
 4. Do not use the product in metal shielding areas and strong magnetic fields, otherwise it will seriously affect the wireless signal transmission of the product.

DISCLAIMERS

- * Our company will update the content of this manual according to the improvement and changes of the product function, and periodically improve and update the software and hardware of the products described in this manual. The update will be displayed in the latest version of this manual without further notice.
- * Due to our continuous adoption of new technologies, if there are any changes in the product parameters, we will not notify separately.
- * This manual is for user reference and guidance only, and does not guarantee that it is completely consistent with the actual product. The actual application shall prevail.
- * The components and accessories described in this manual do not represent the standard configuration of the product. The specific configuration shall be subject to the package.
- * All text, tables, and pictures in this manual are protected by relevant national laws and regulations, and may not be used without our company's permission.